

VEX[®]

ROBOTICS

COMPETITION

TOWER TAKEOVER

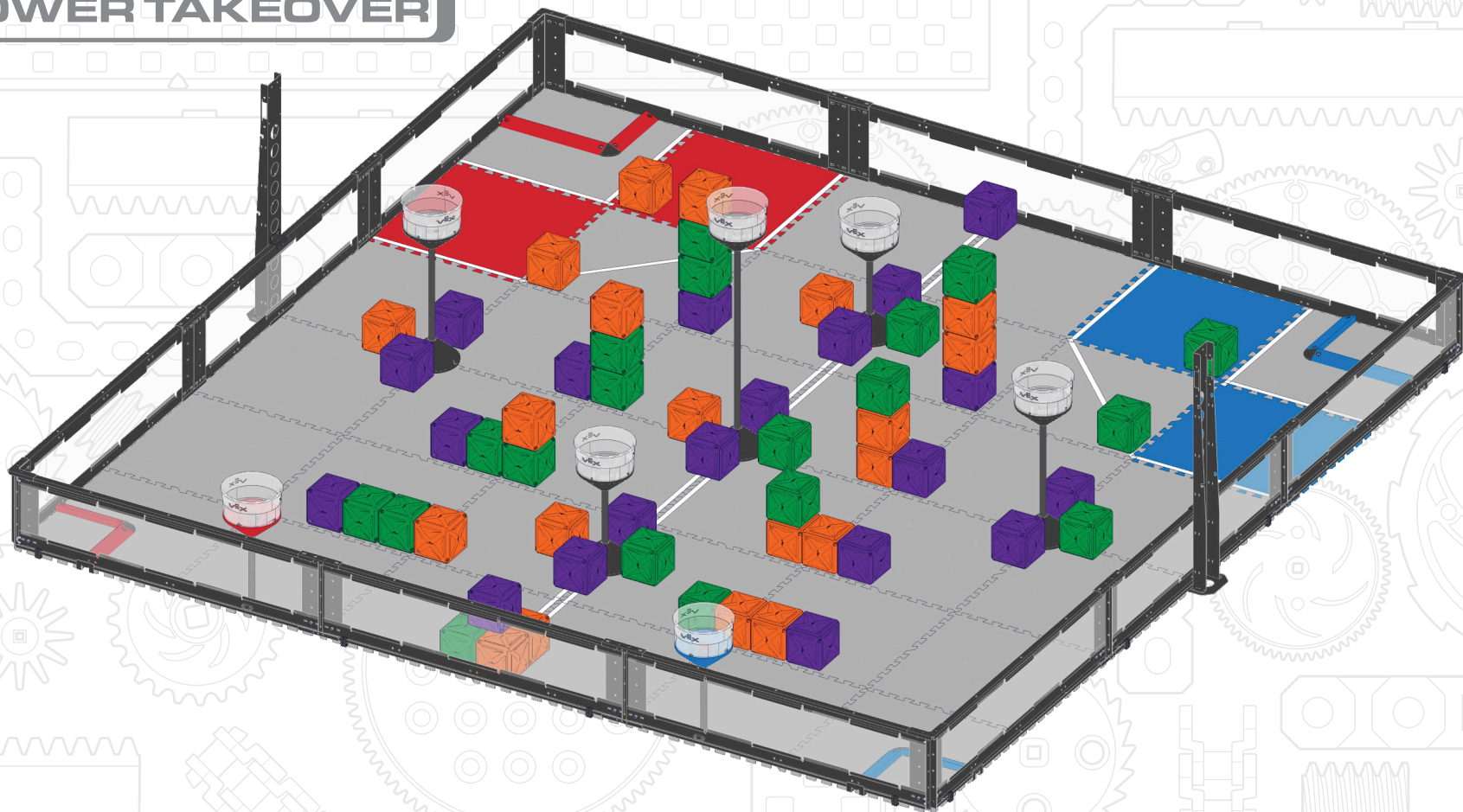



Field Build Instructions

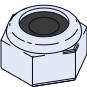

276-6093-750

Parts List

  **76x 8-32 Nylock**
276-1027-001

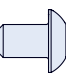
 **32x 0.25 in**
276-4990-001

 **68x 0.5 in**
276-4992-001

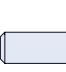
 **8x 0.625 in**
276-4993-001

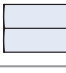
 **16x 0.5 in**
275-1014-001

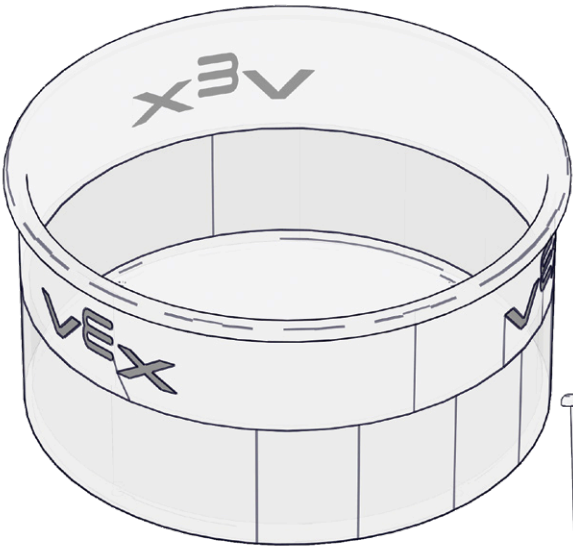

7x 276-6089-011

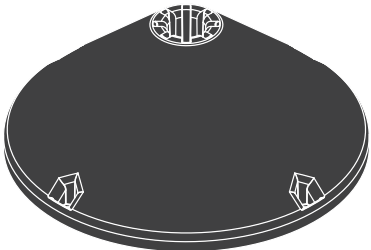

10x 276-6089-012

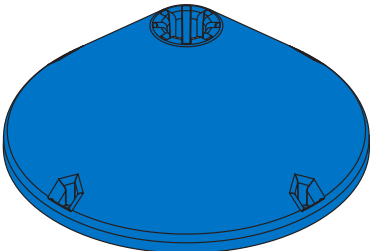

1x 276-6089-016

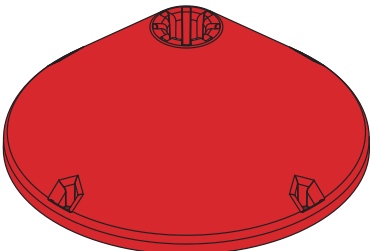

1x 276-6089-017

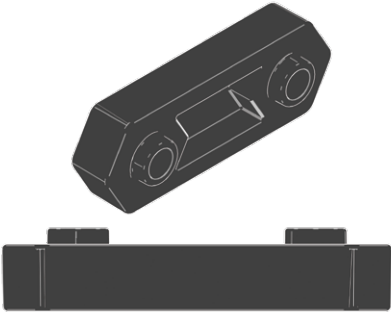

4x 276-5677-019

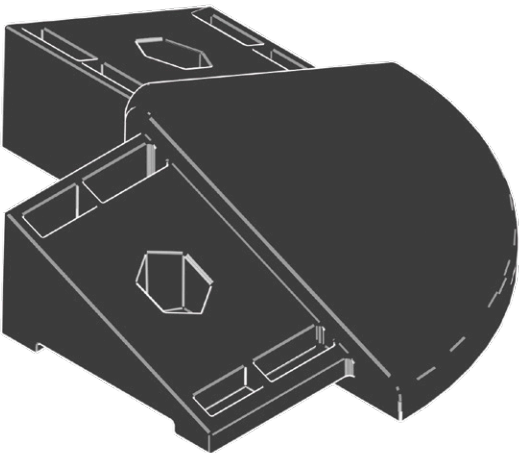

4x 276-6089-019

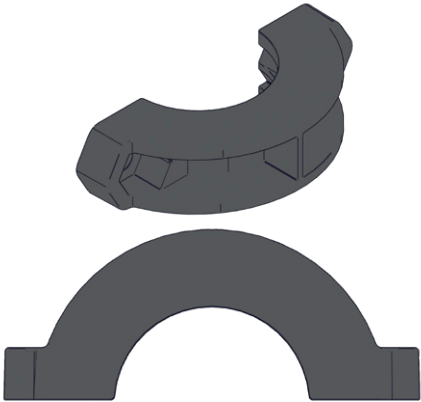
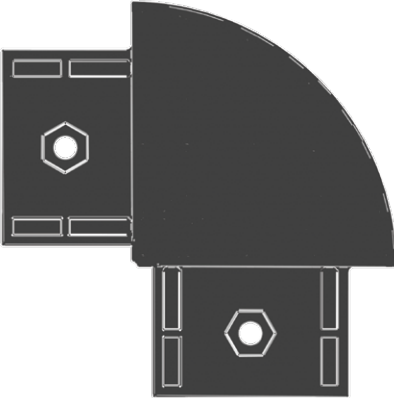

24x 276-6089-013

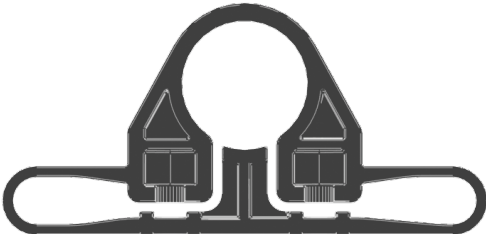

4x 276-5677-006

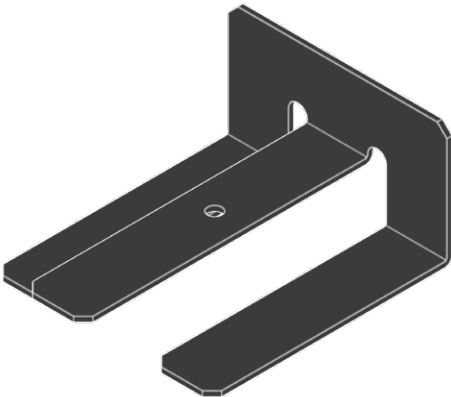
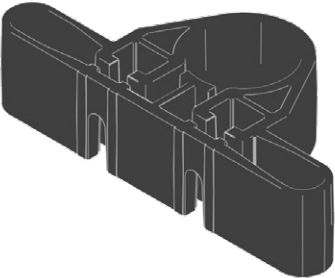

8x 276-6089-015

3x
10in
(254mm)
276-6089-004

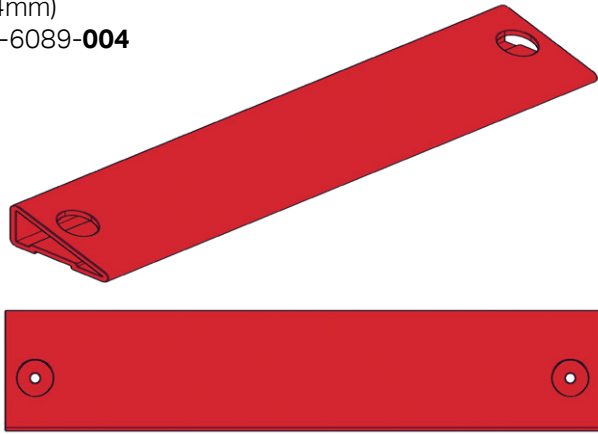

1x
15.5in
(393.7mm)
276-6089-006

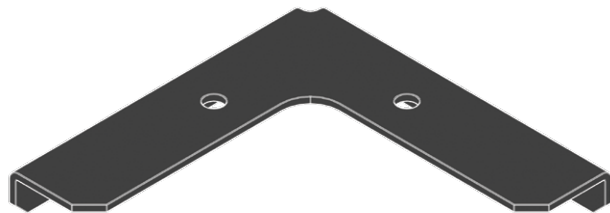
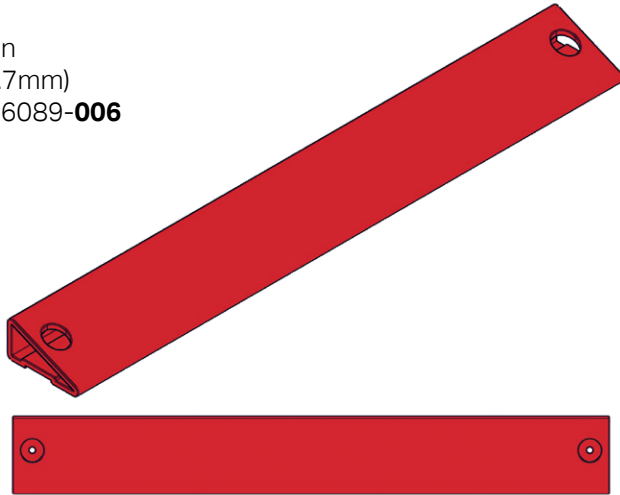

4x 276-6089-018

3x
10in
(254mm)
276-6089-005

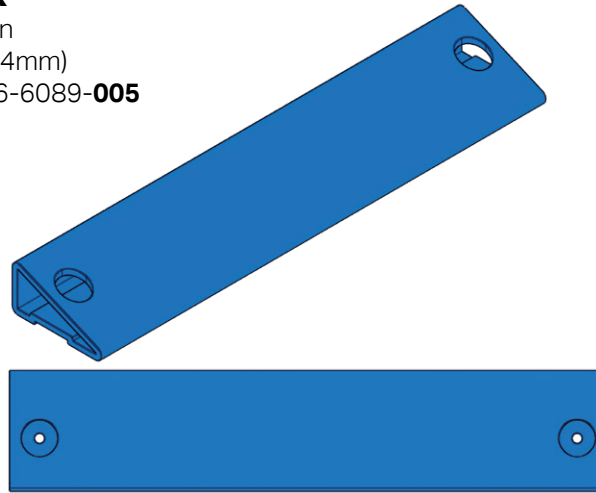

1x
15.5in
(393.7mm)
276-6089-007

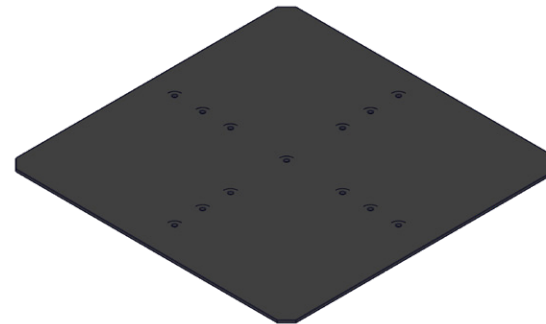
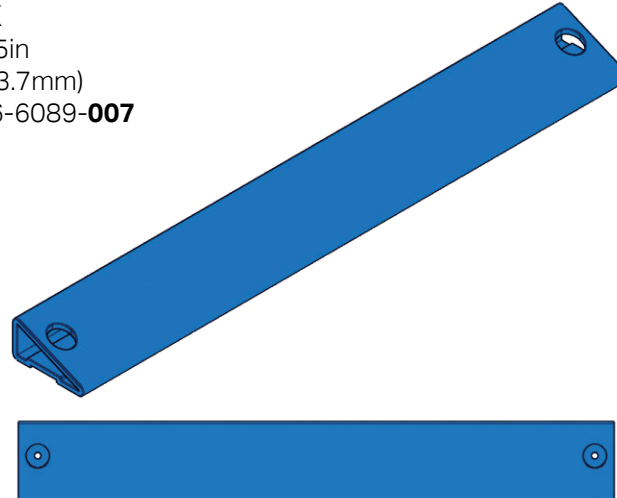

5x 276-4847-011

1x
33.5 in
(850.9 mm) Pipe
276-6089-010



2x
20.25 in
(514.35 mm) Pipe
276-6089-009



4x
14.25 in
(361.95 mm) Pipe
276-6089-008



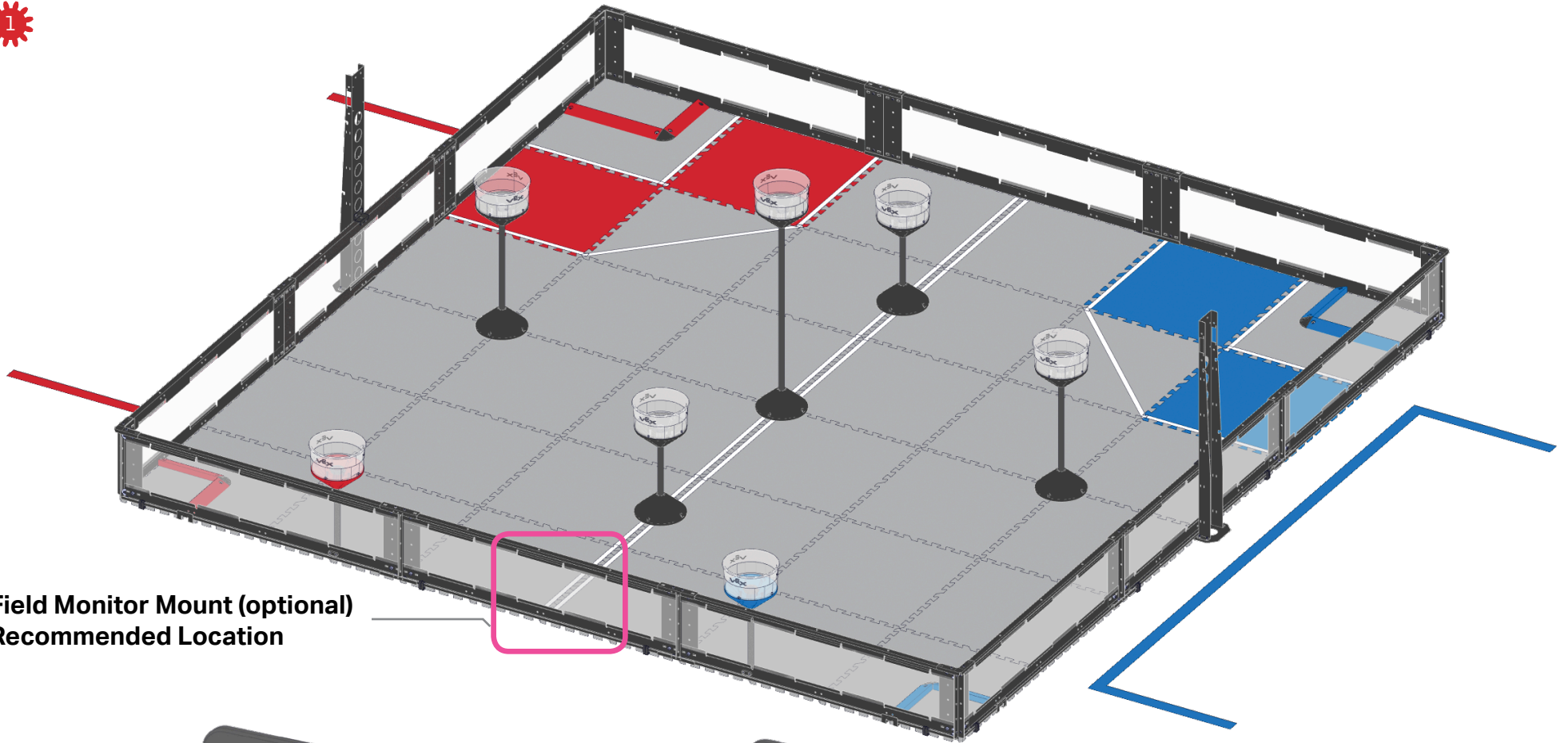

Field Monitor Mount (optional)
Recommended Location

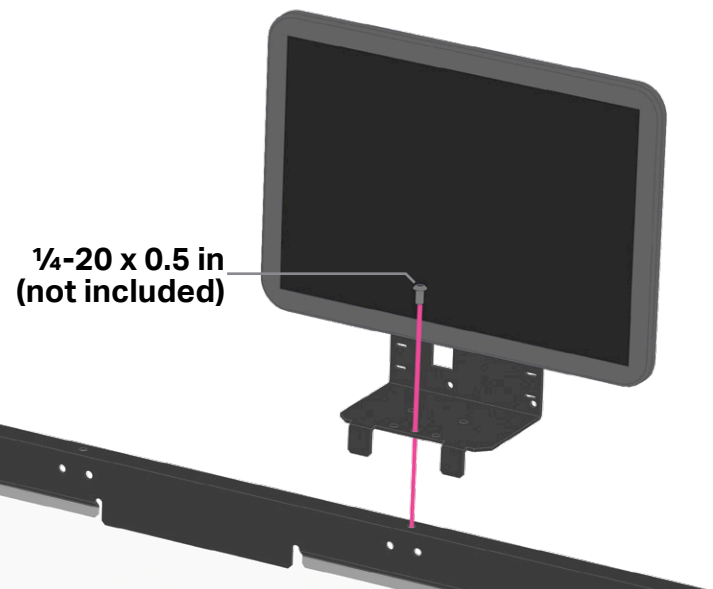

1/4-20 x 0.5 in
(not included)



2

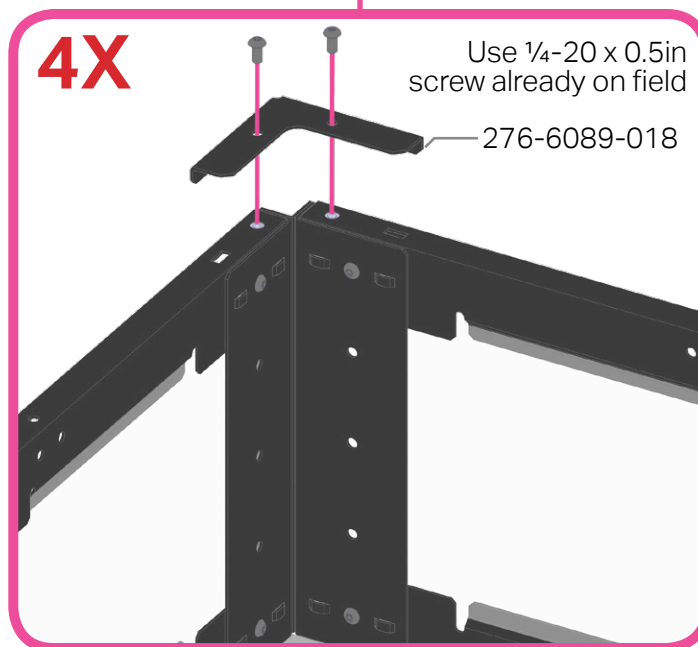
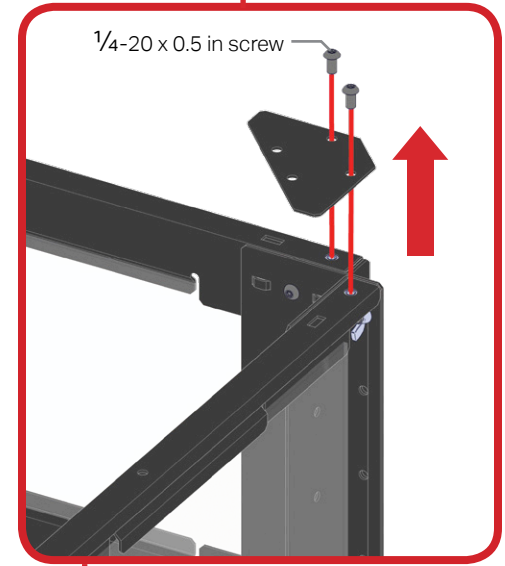
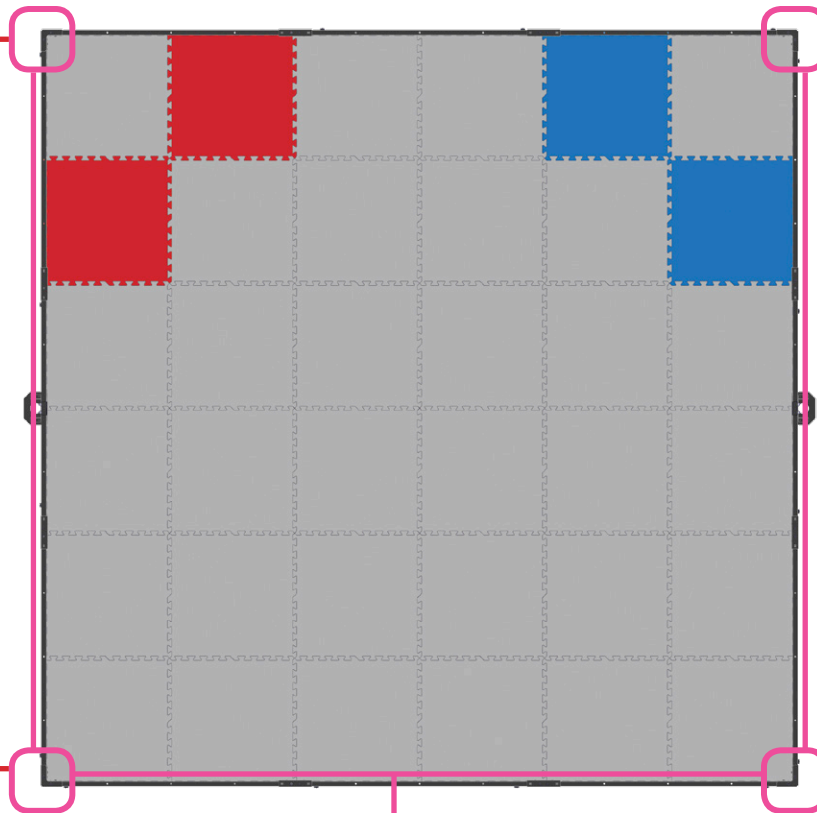
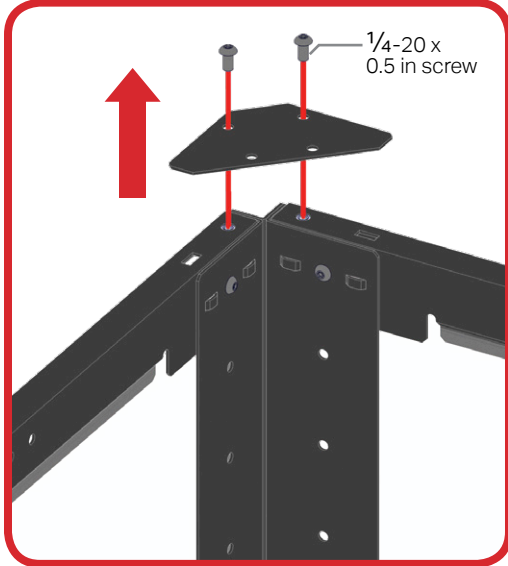

3 5X

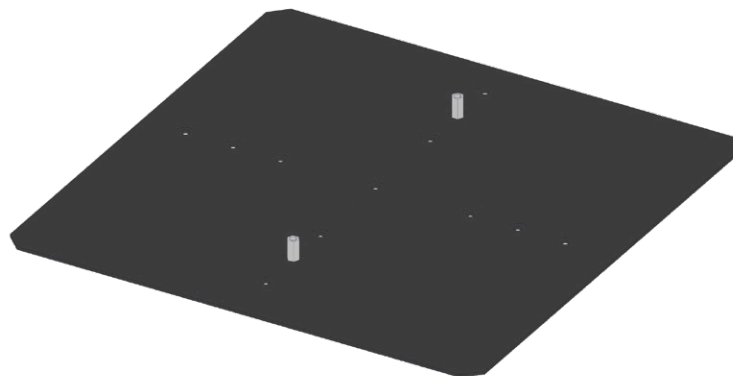
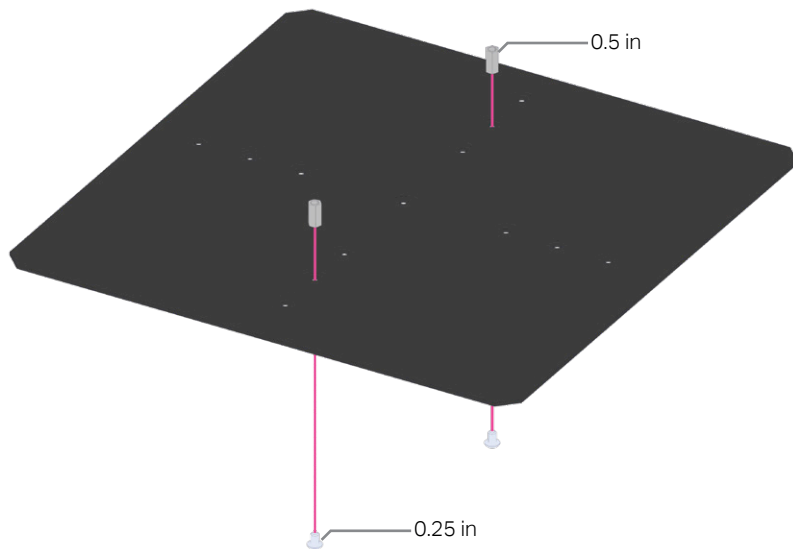
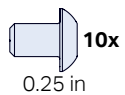
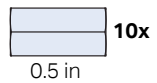

4

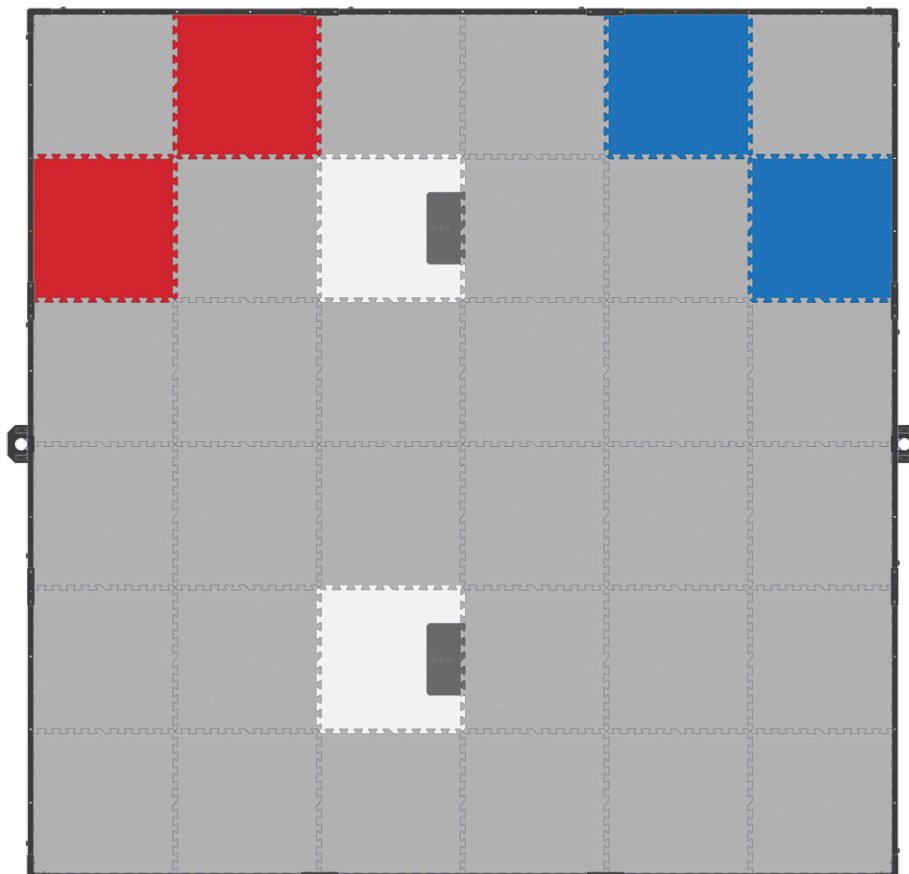
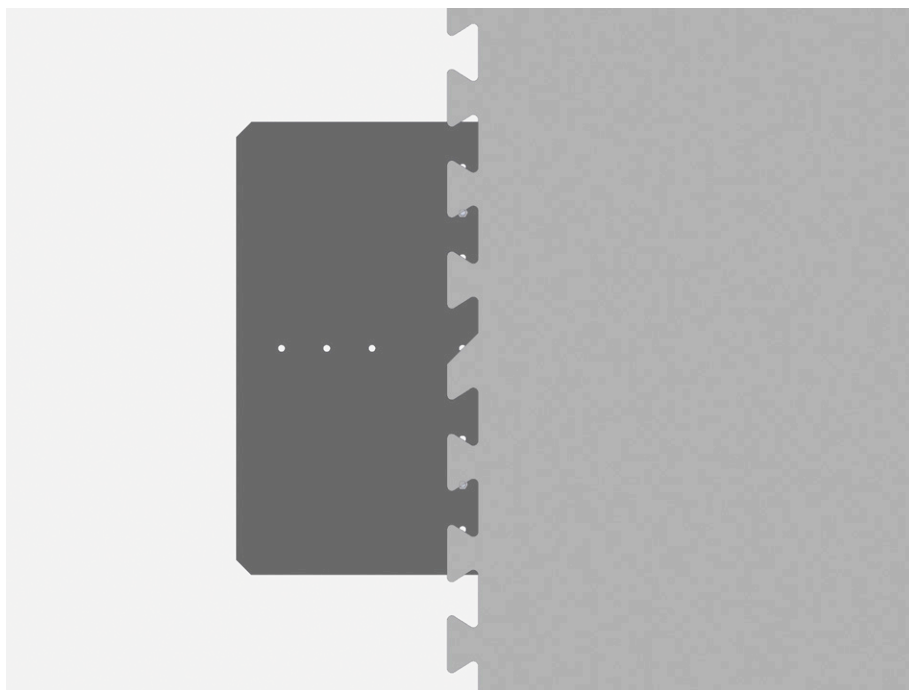

5 3X

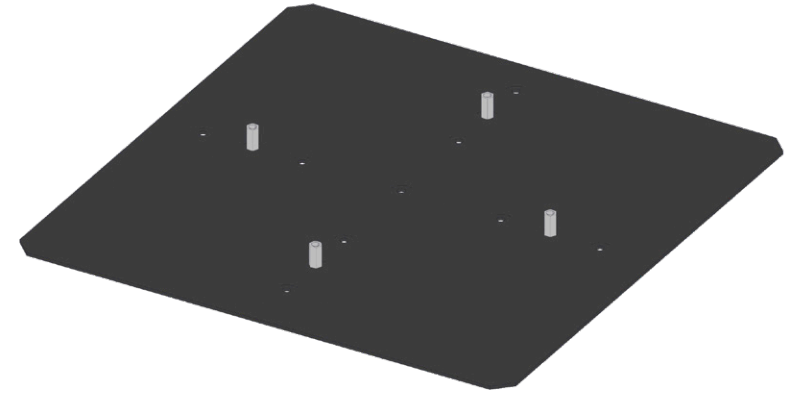
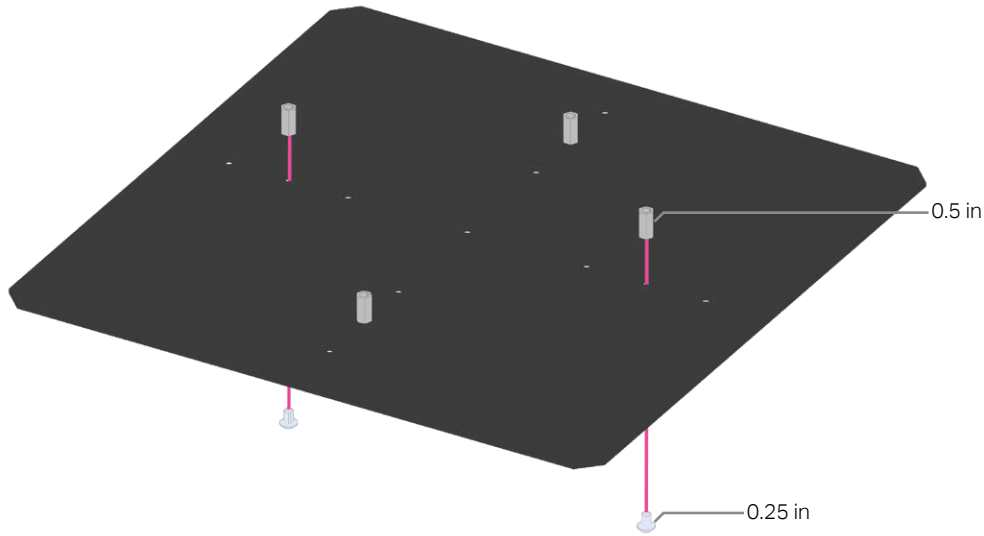
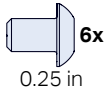
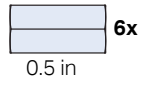

6

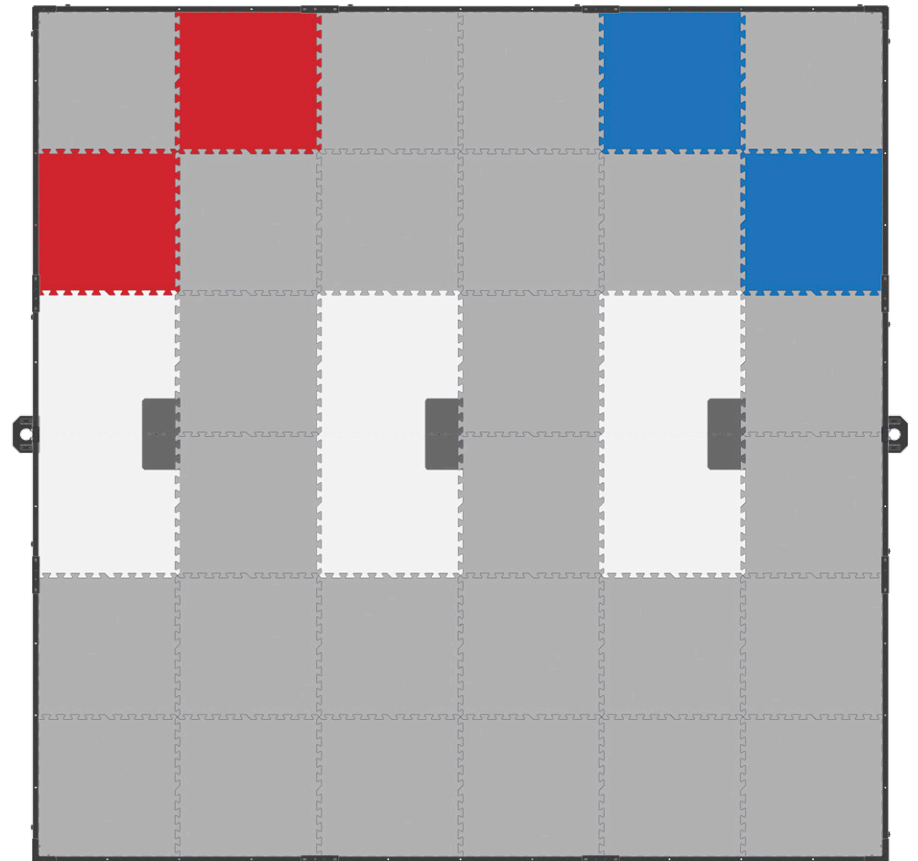
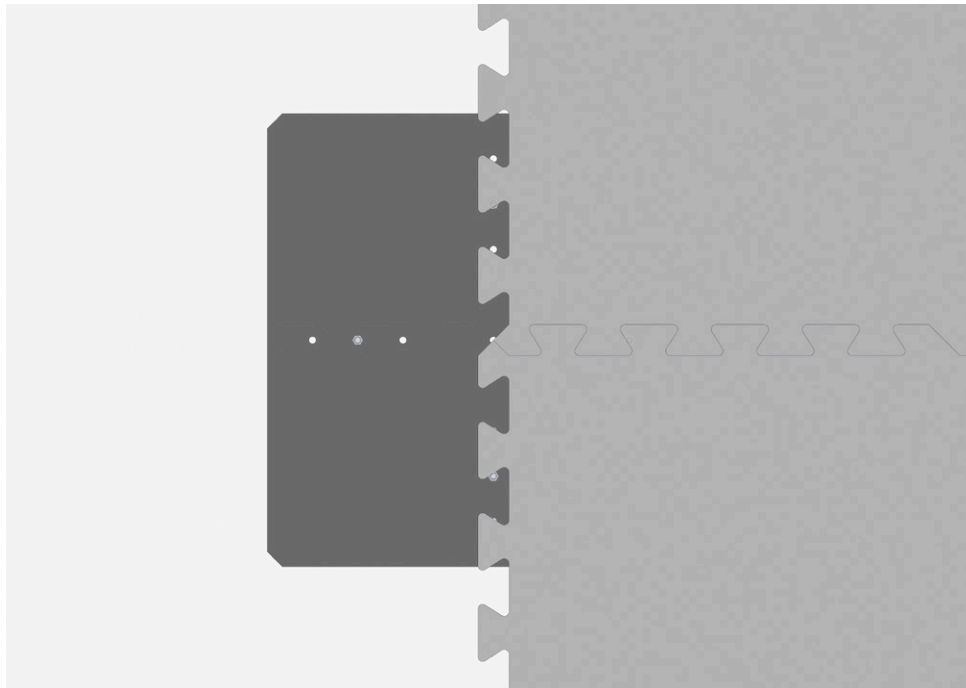



There are (12x) strips of 3/4 in White Electrical Tape on the Field, as shown below:

16x  = Tuck tape under tile

IMPORTANT NOTE:

DO NOT stretch tape when applying to the foam tile floor. For best results, smooth out any bubbles that form during application.

To prevent tape lines from being pulled up during competition, it is recommended that the ends of the tape are tucked into tile seams.

Note: Tabs on the foam tiles may be mirrored on your field.

Pro-Tip:

If the tiles will be used at multiple events, it is not necessary to remove the tape. Simply cut the tape at tile seams and note the order of the tiles when they are stored.

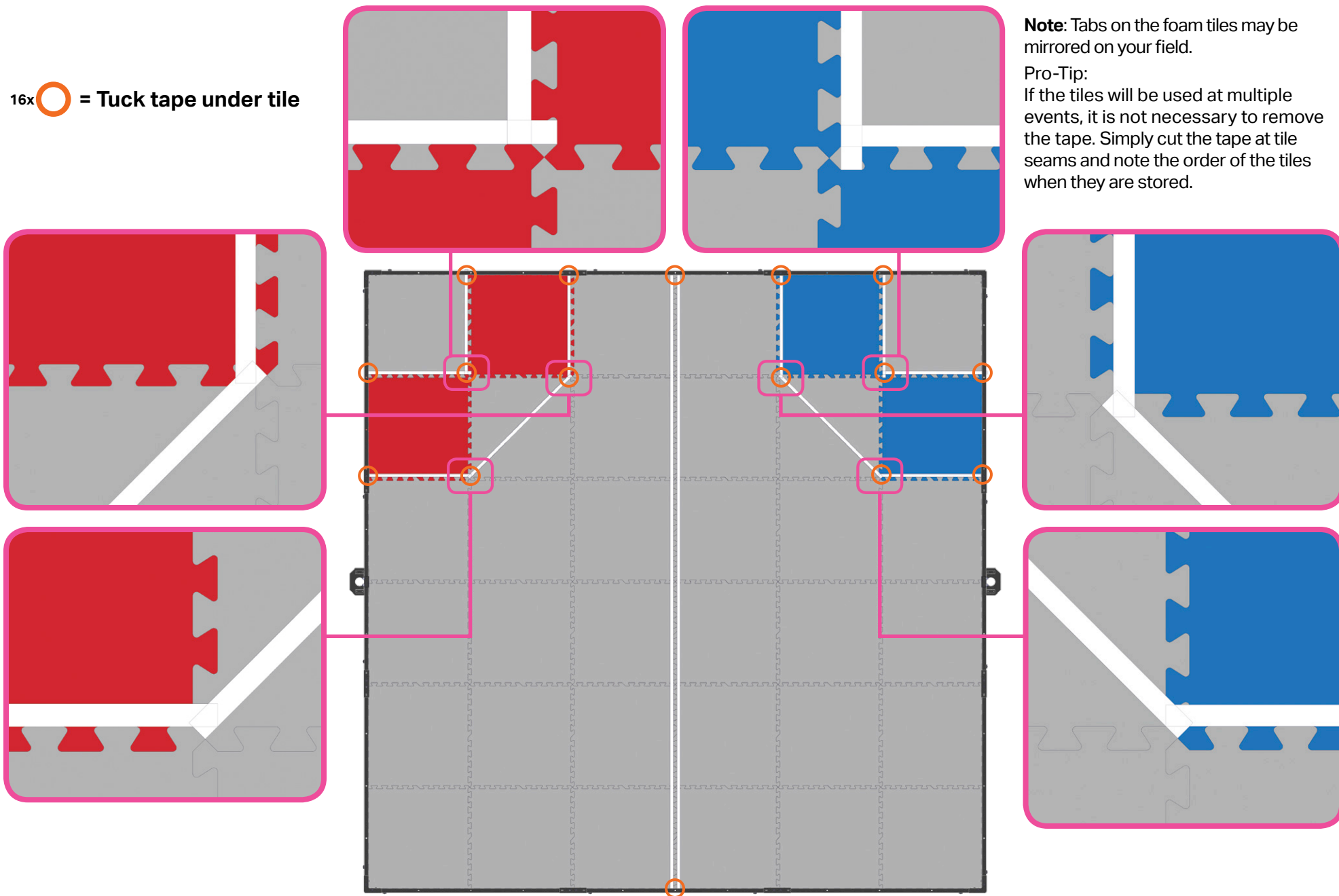

8

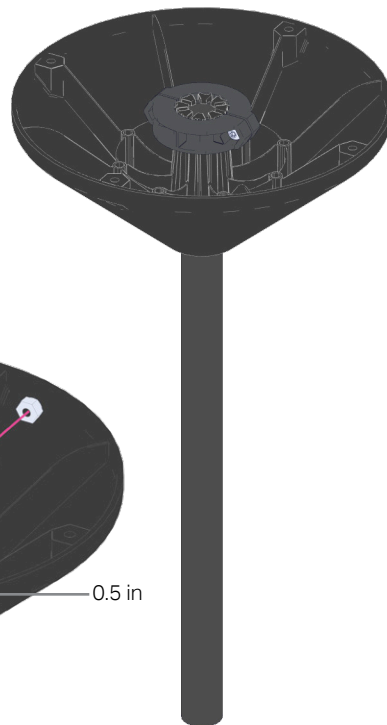
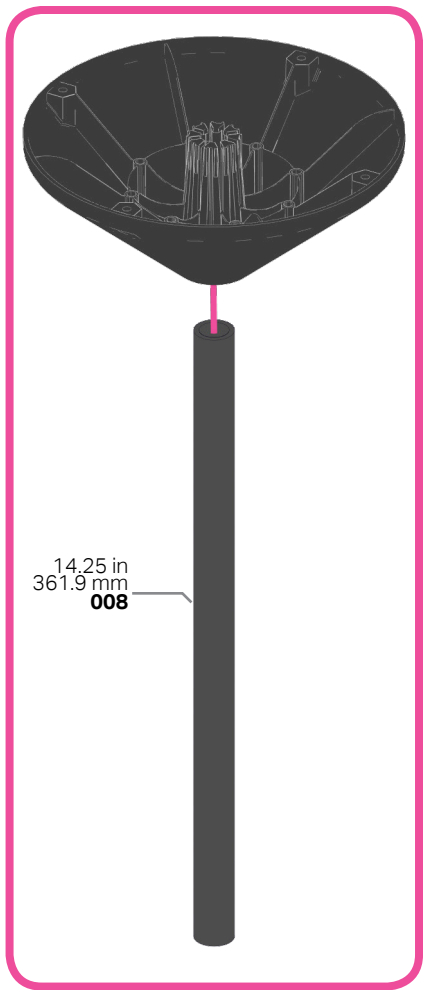

8-32 Nylock

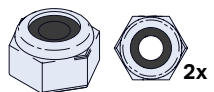

8-32 Nylock

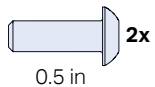

0.5 in

9

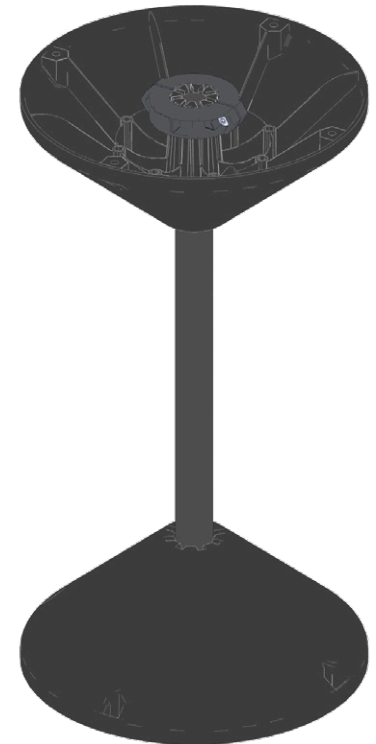
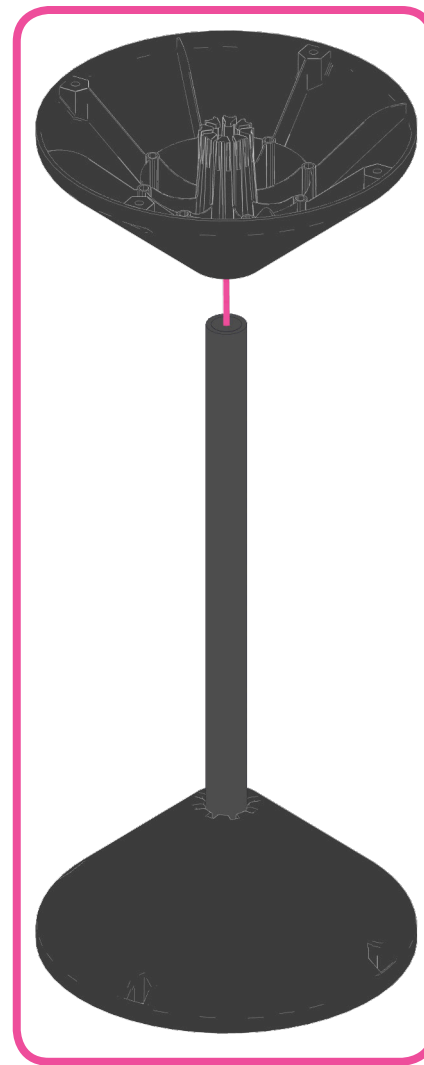

8-32 Nylock

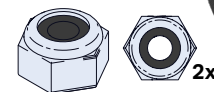

8-32 Nylock

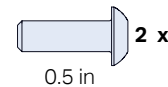

0.5 in

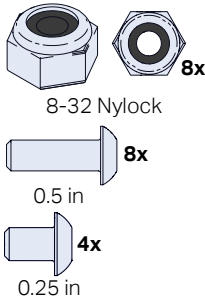
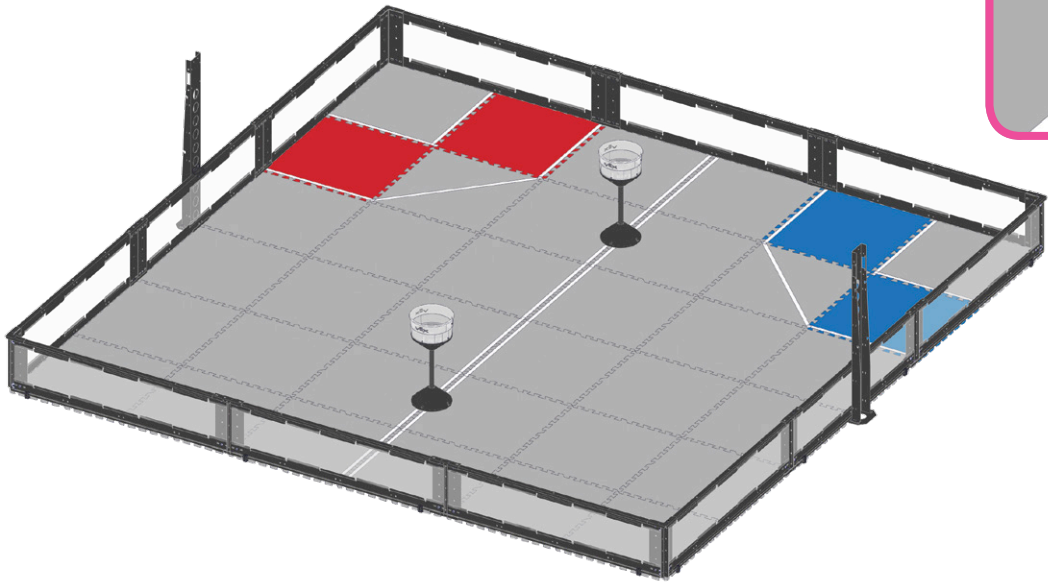
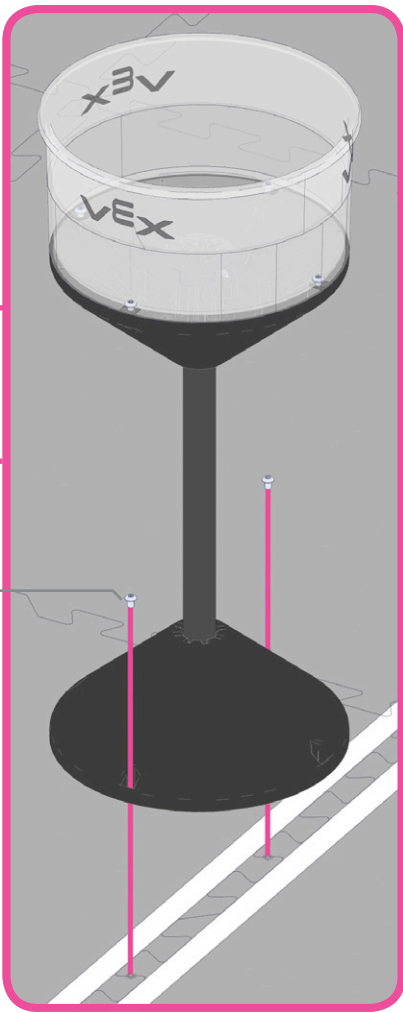
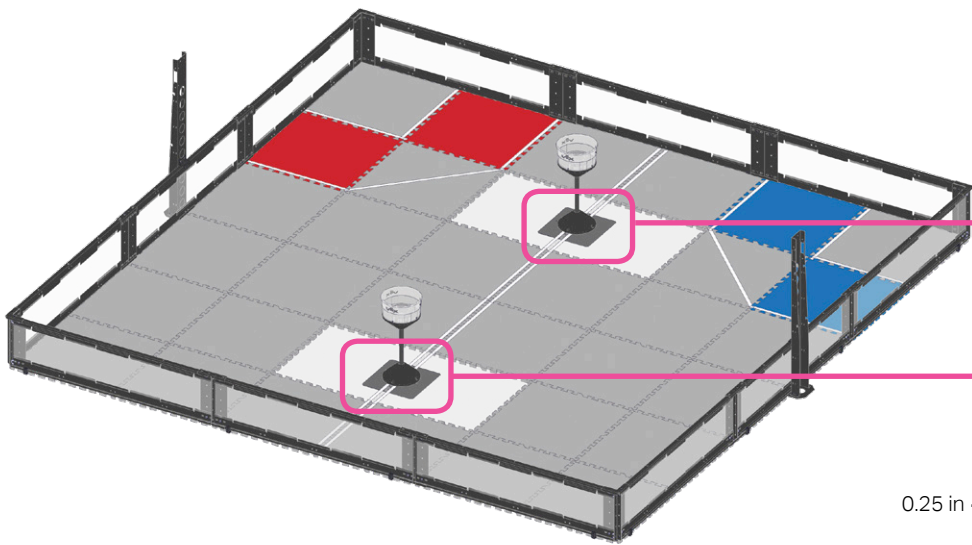
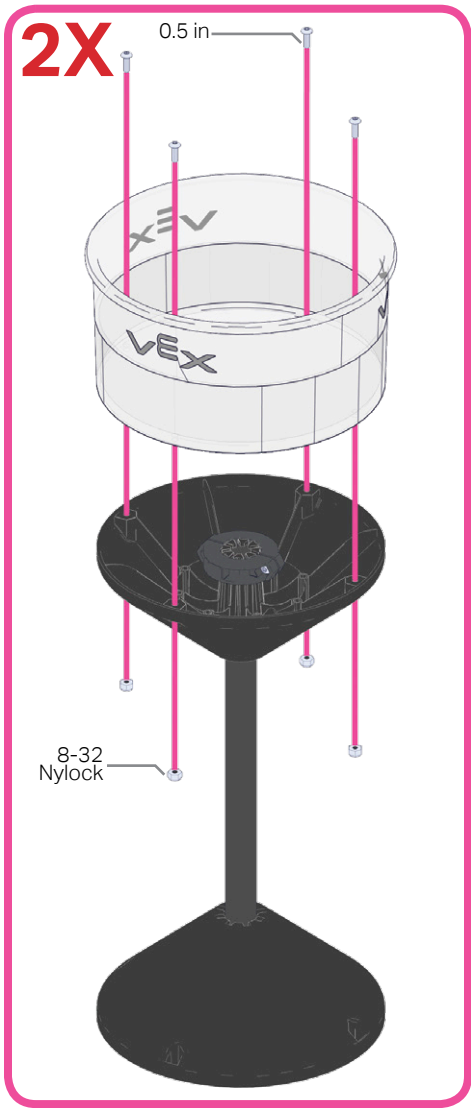

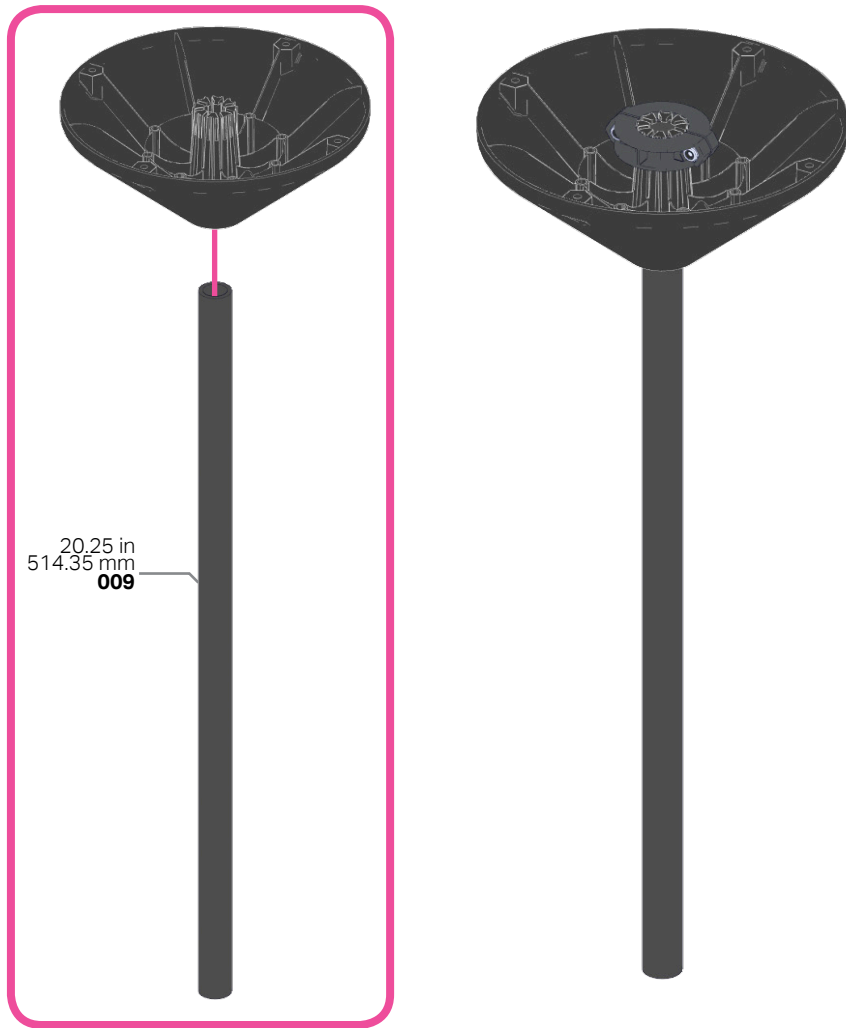

20.25 in
514.35 mm
009

8-32 Nylock

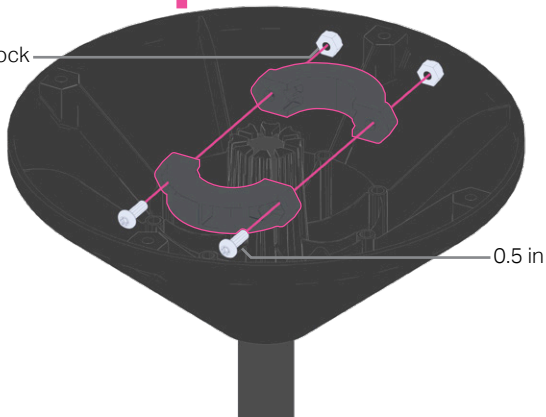
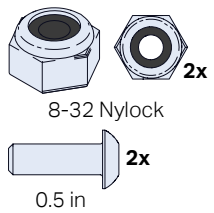

0.5 in



8-32 Nylock

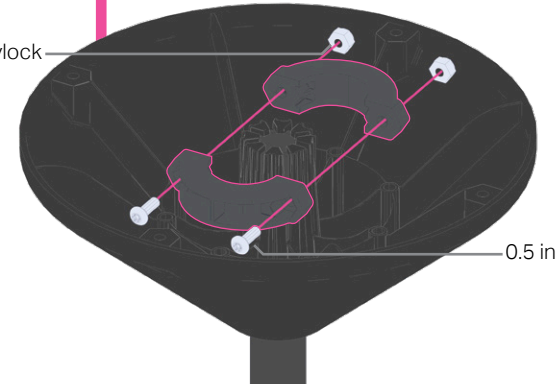
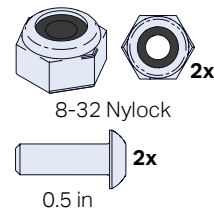

0.5 in

2X

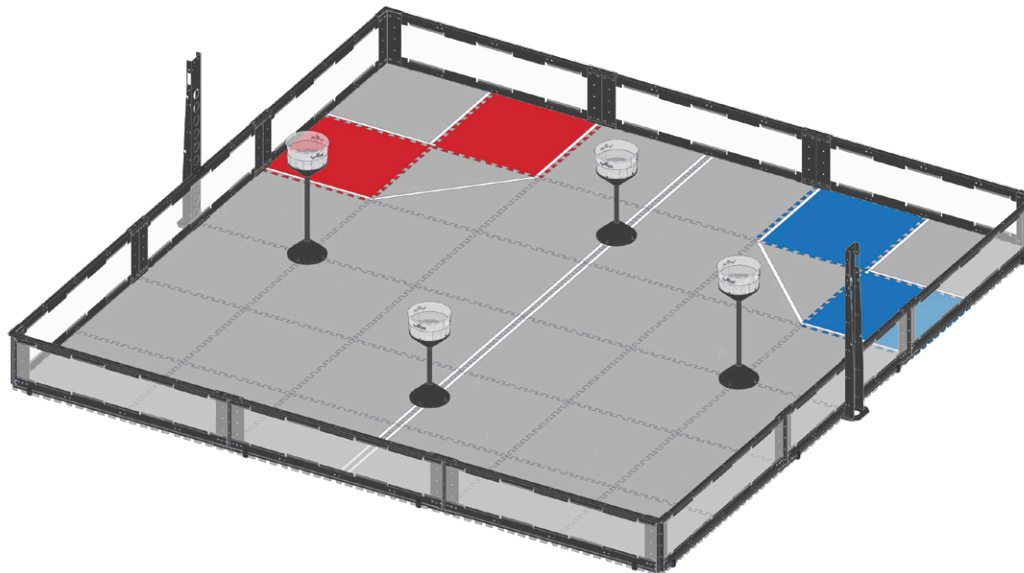
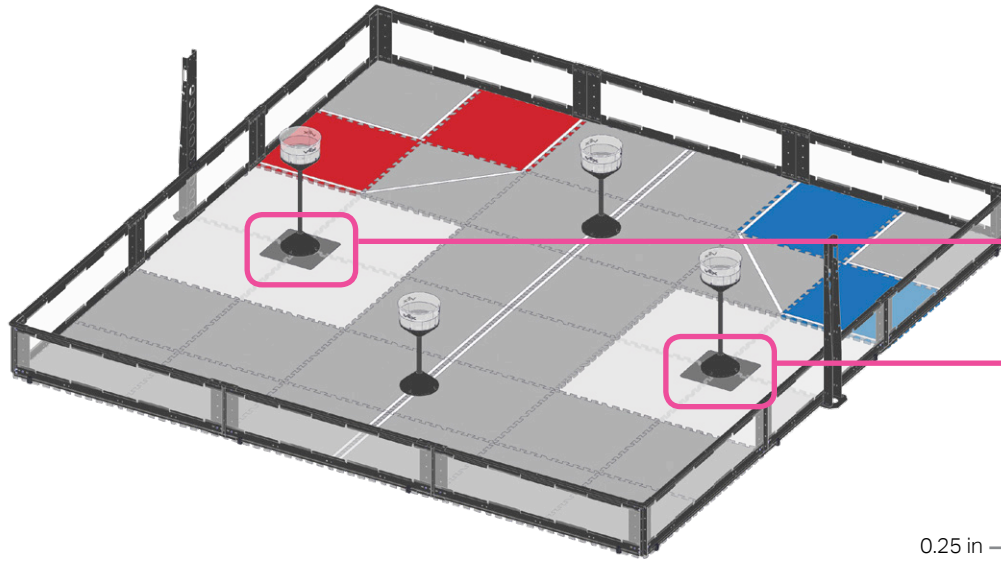
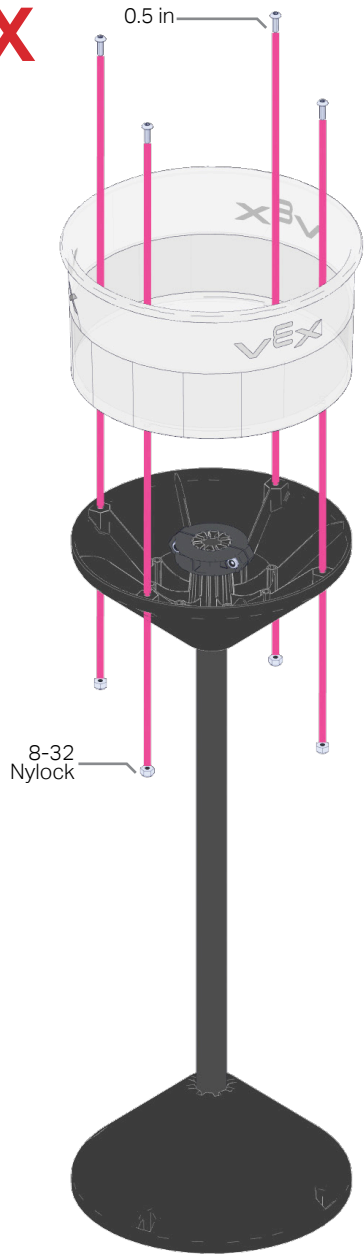

0.25 in

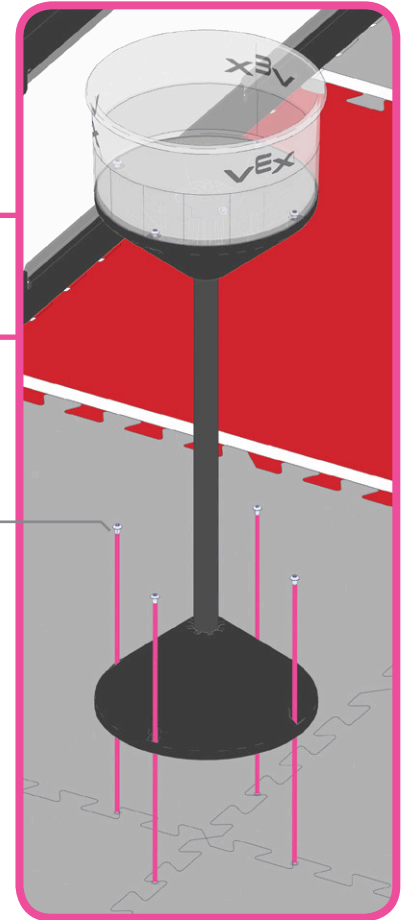

- 8x 8-32 Nylock
- 8x 0.5 in
- 4x 0.25 in

14

33.5 in
850.9 mm
010

8-32 Nylock

0.5 in

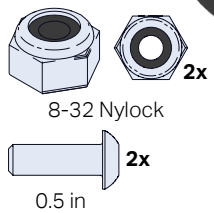

15

8-32 Nylock

0.5 in

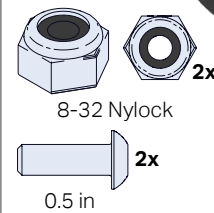

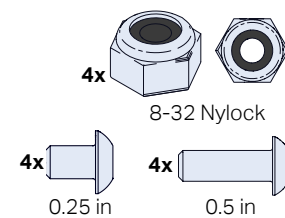
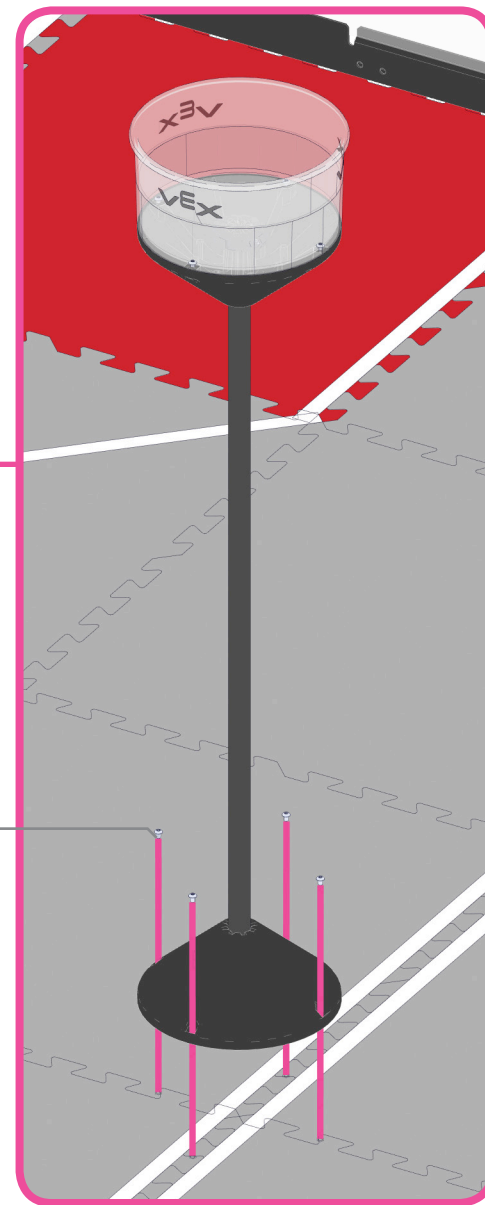
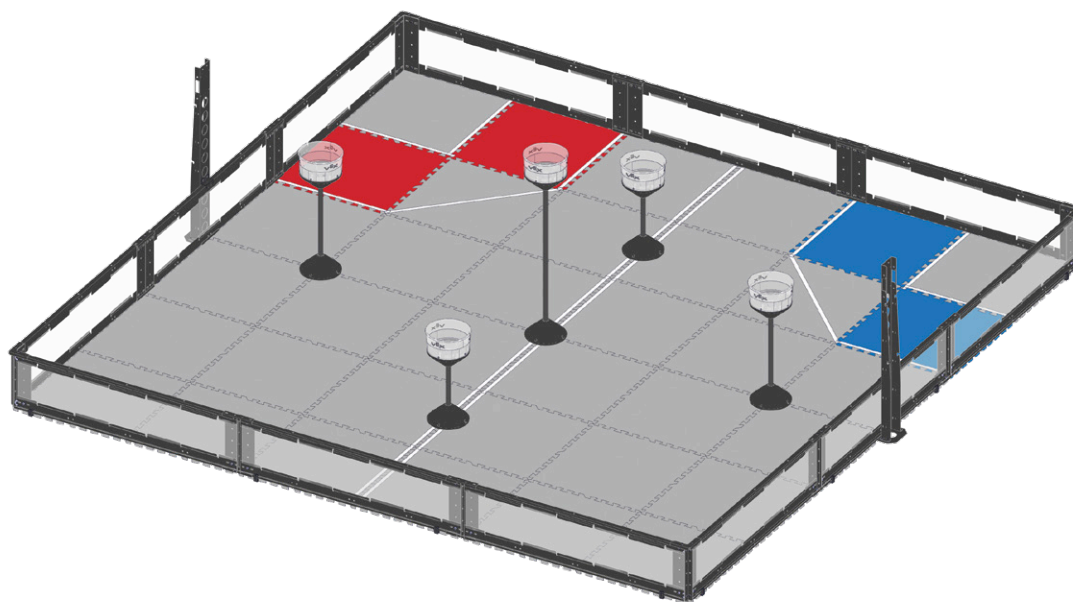
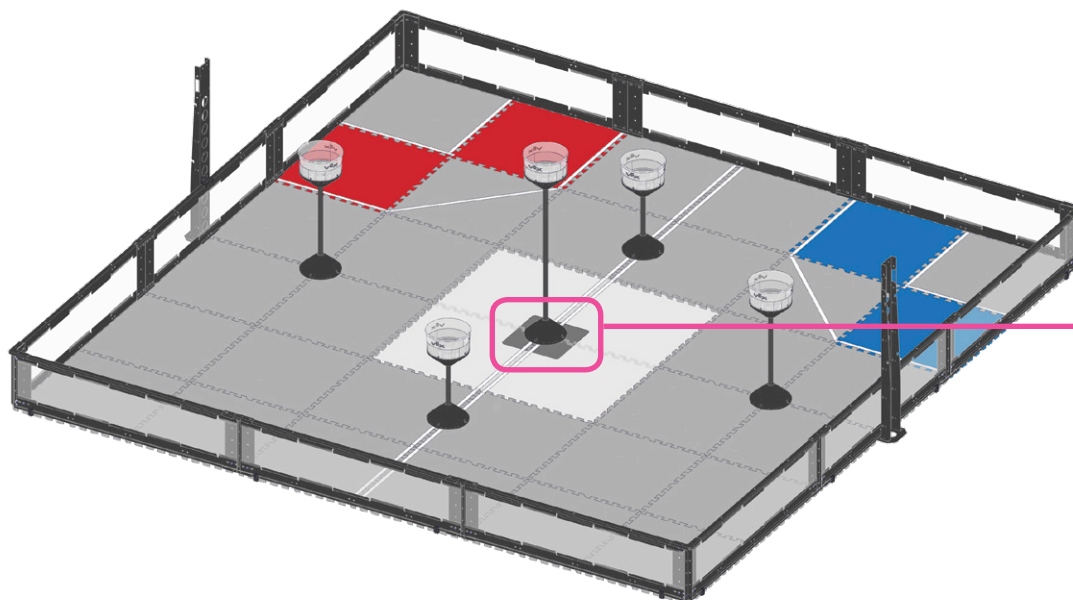
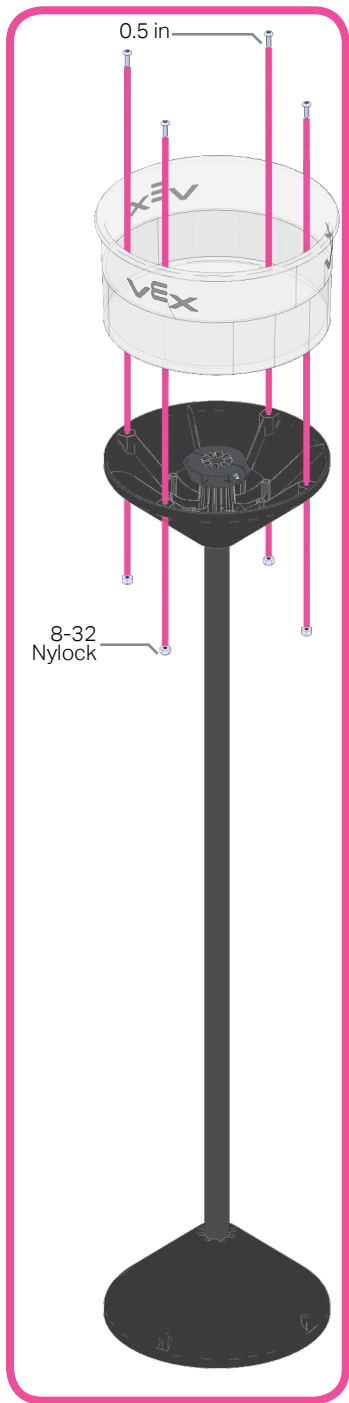

17

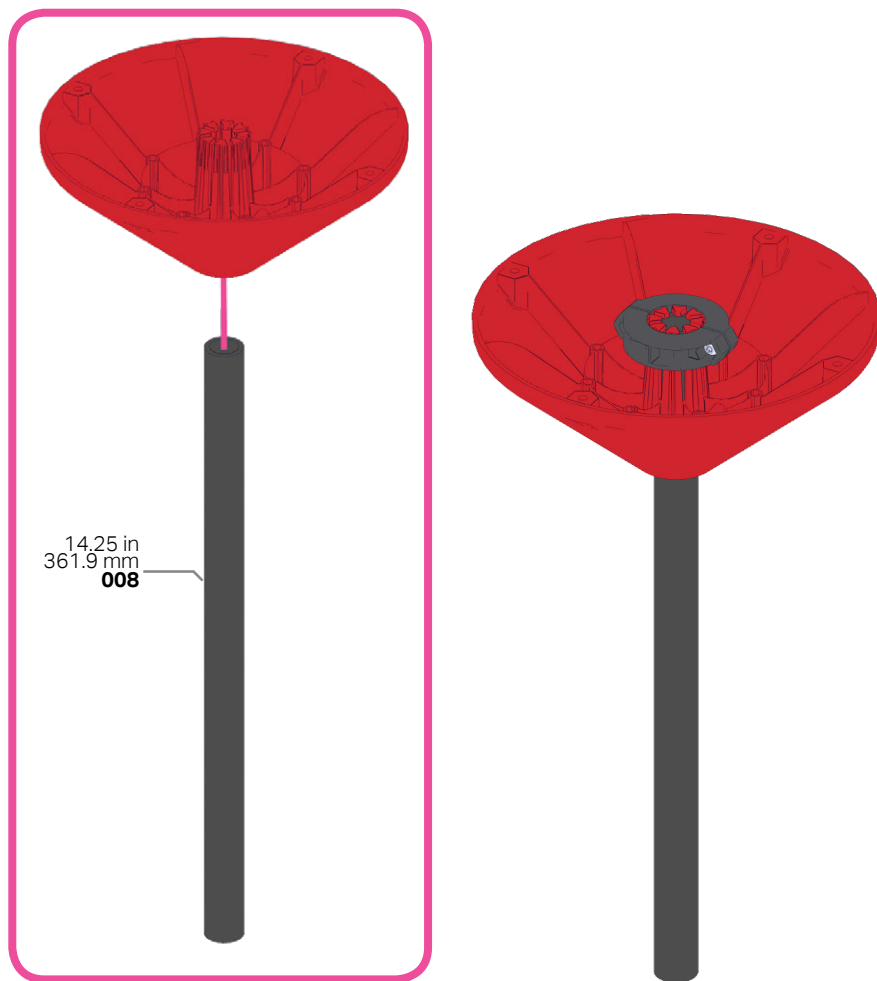

8-32 Nylock

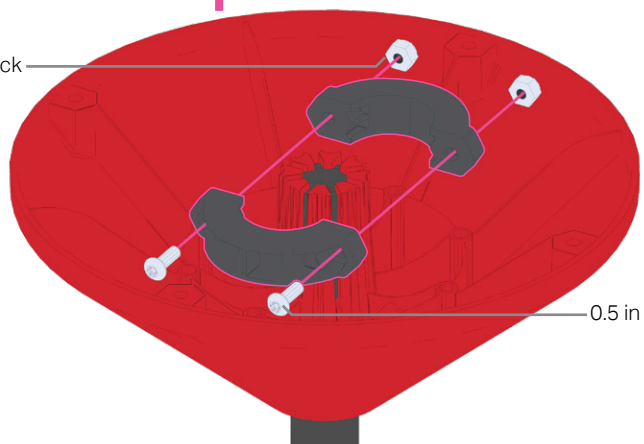
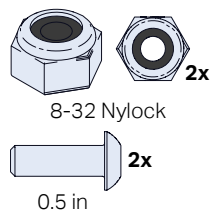

18

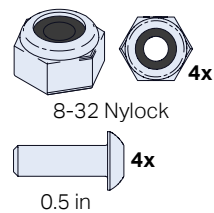
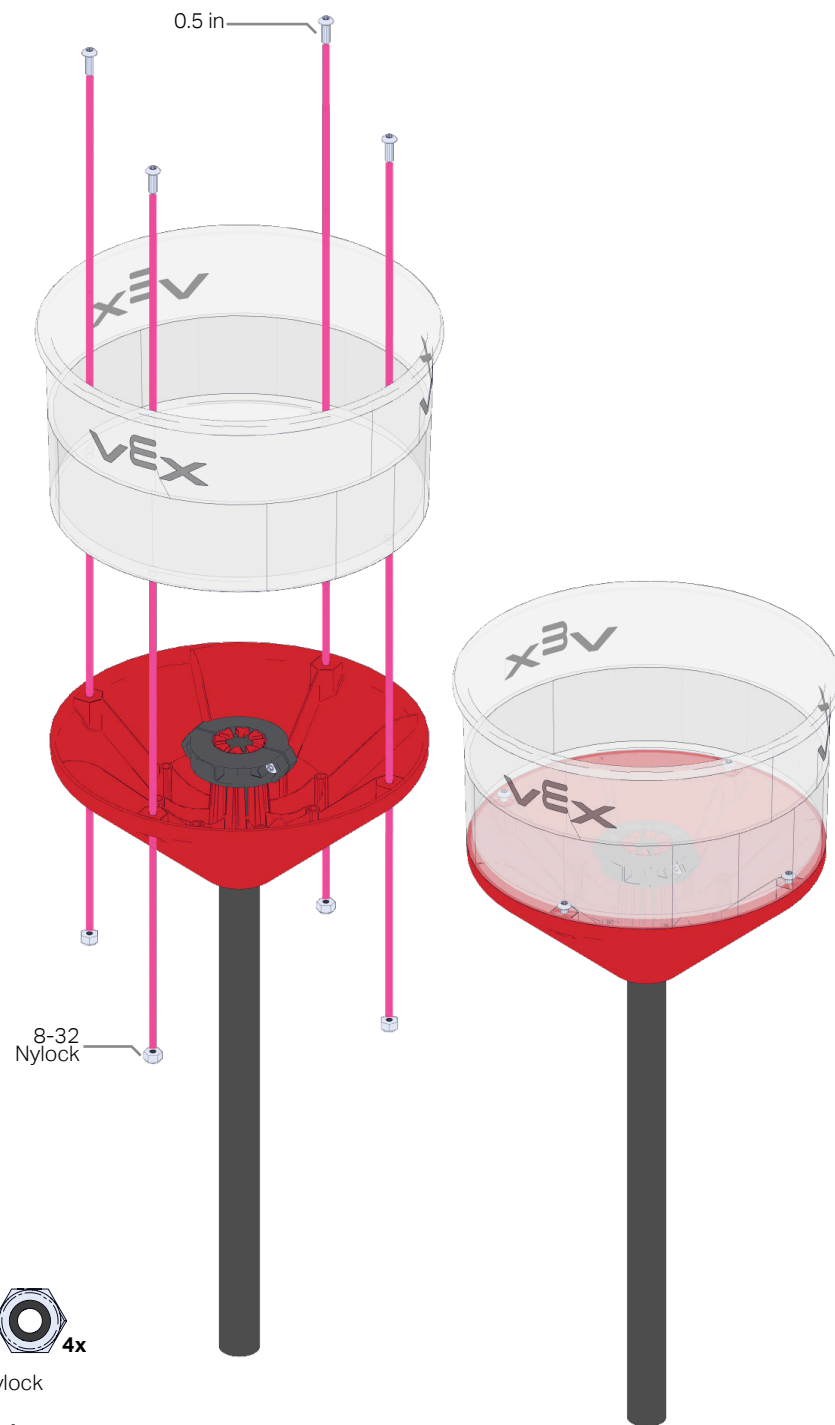

19

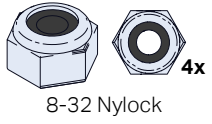

2X

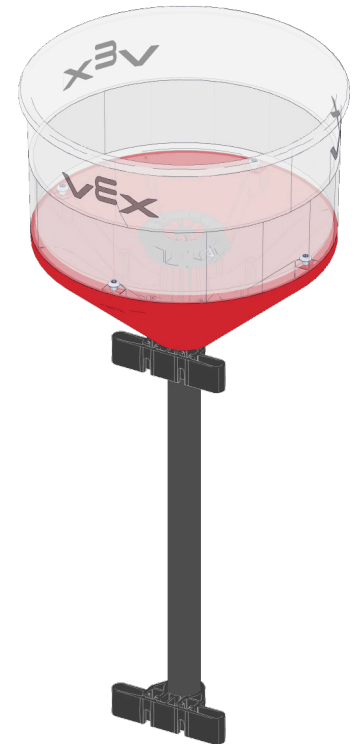
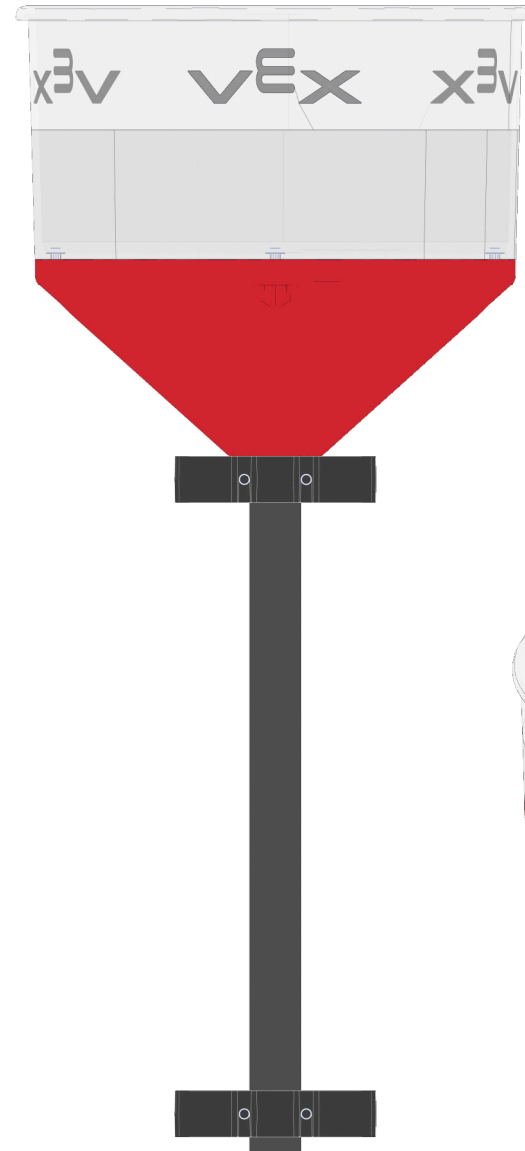
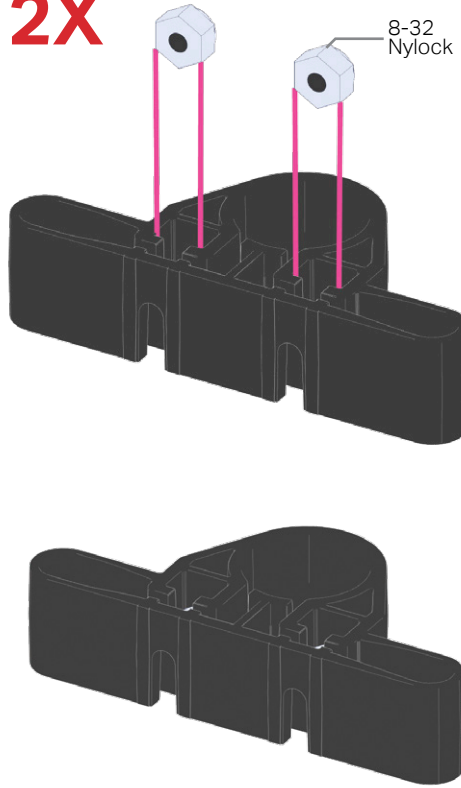

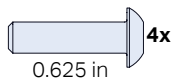
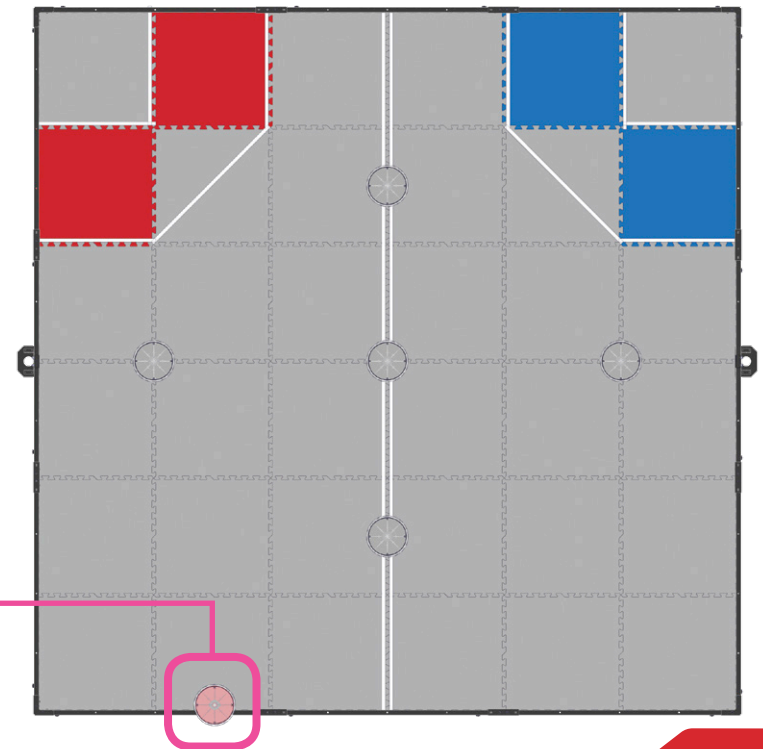
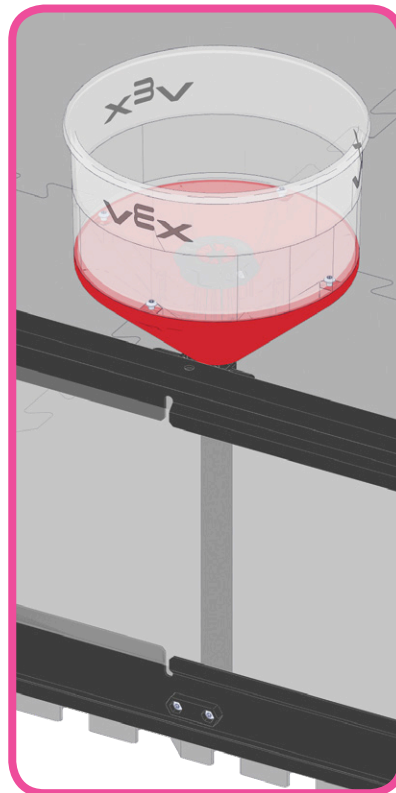
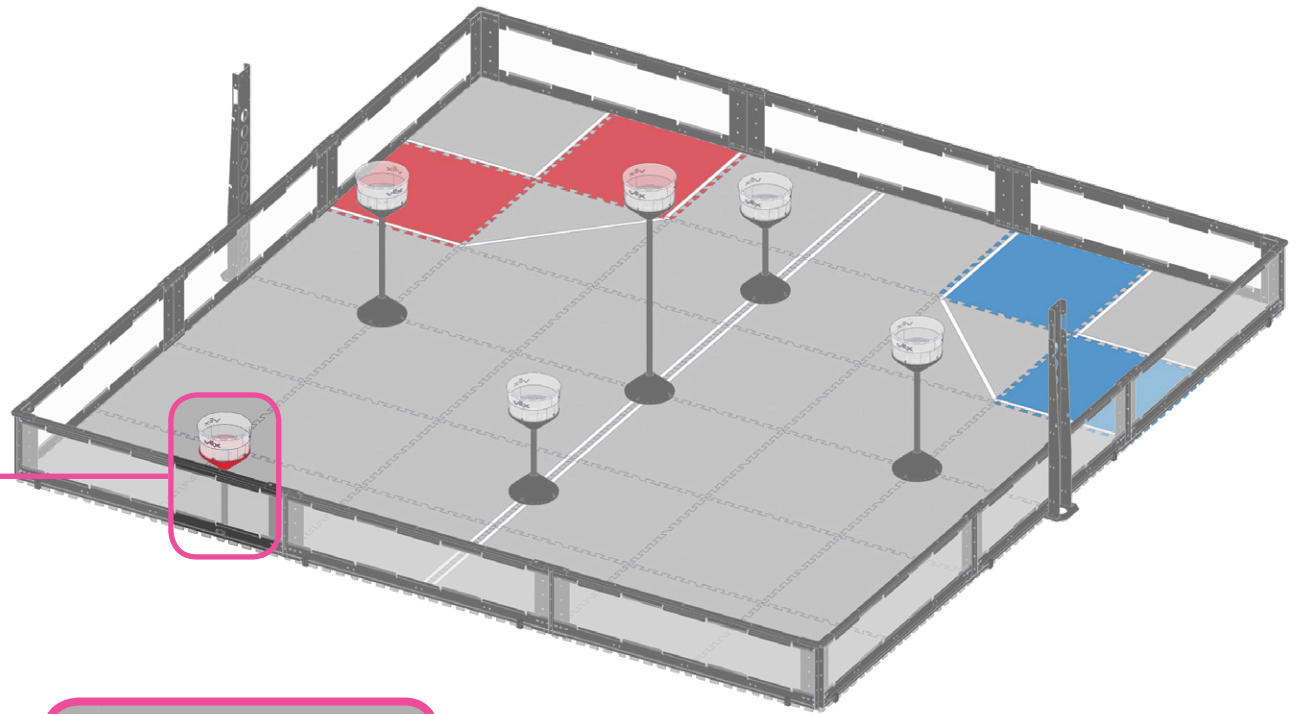
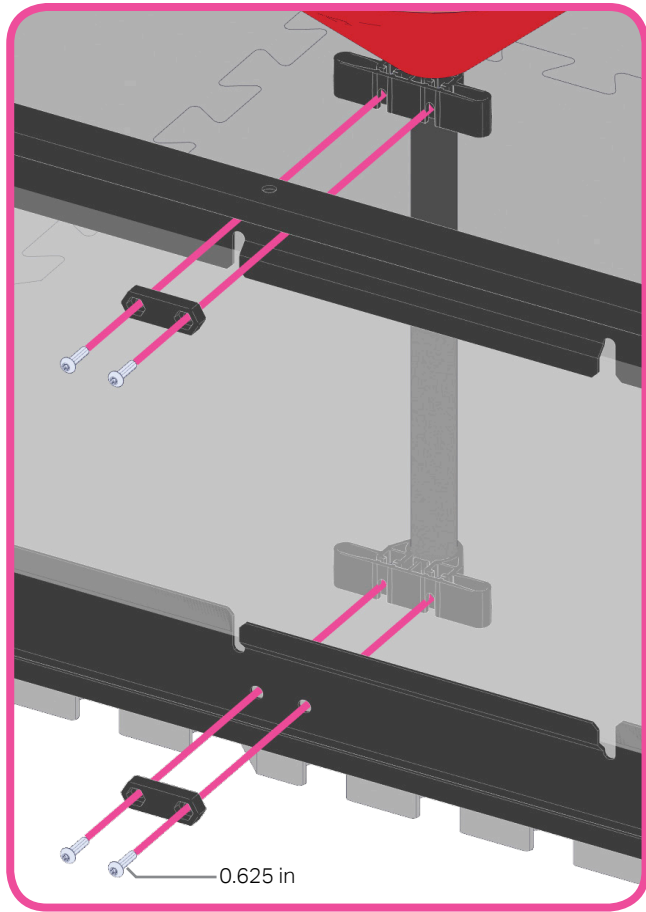

21

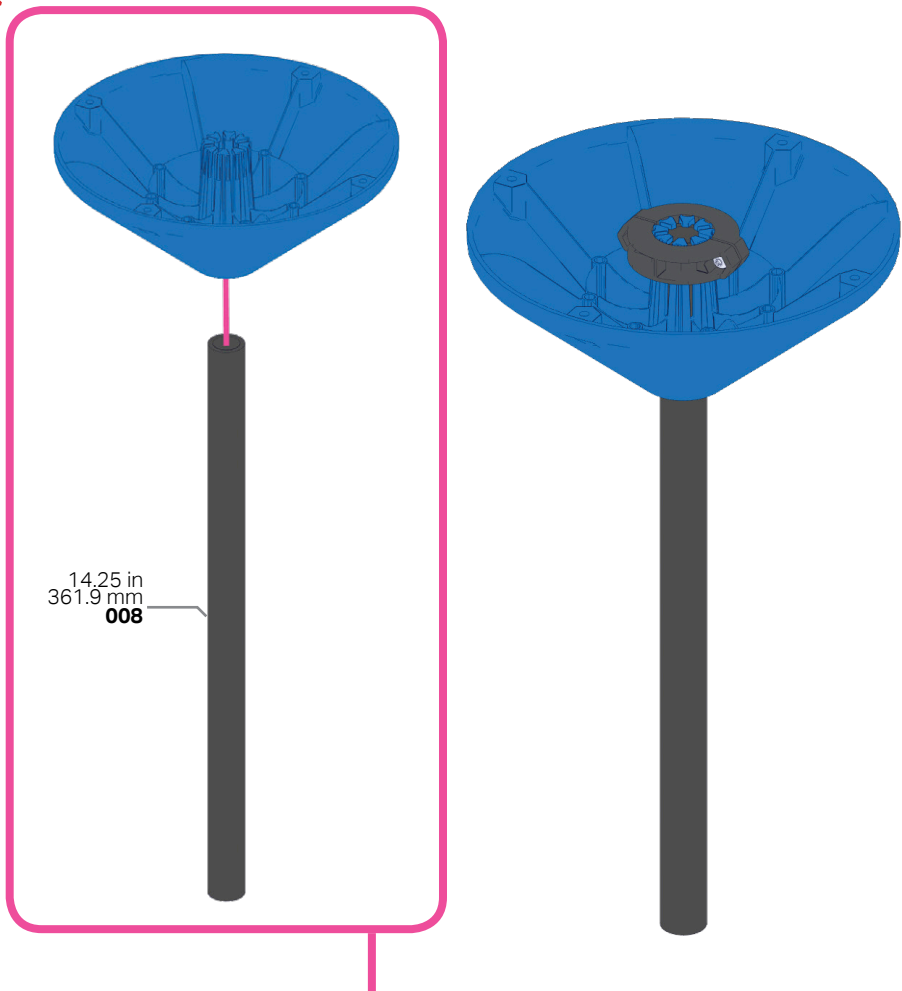

8-32 Nylock

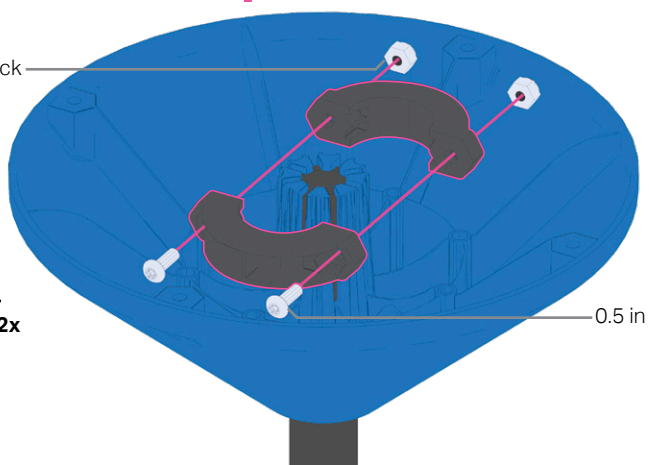
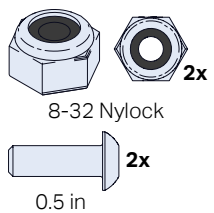

22

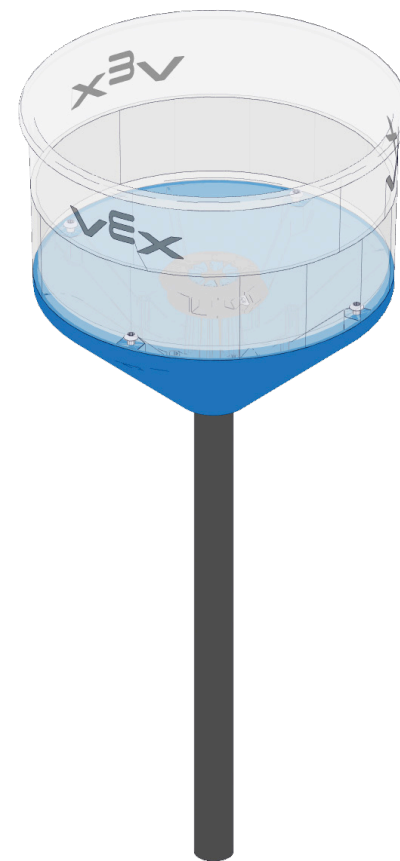
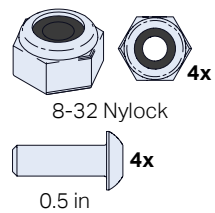
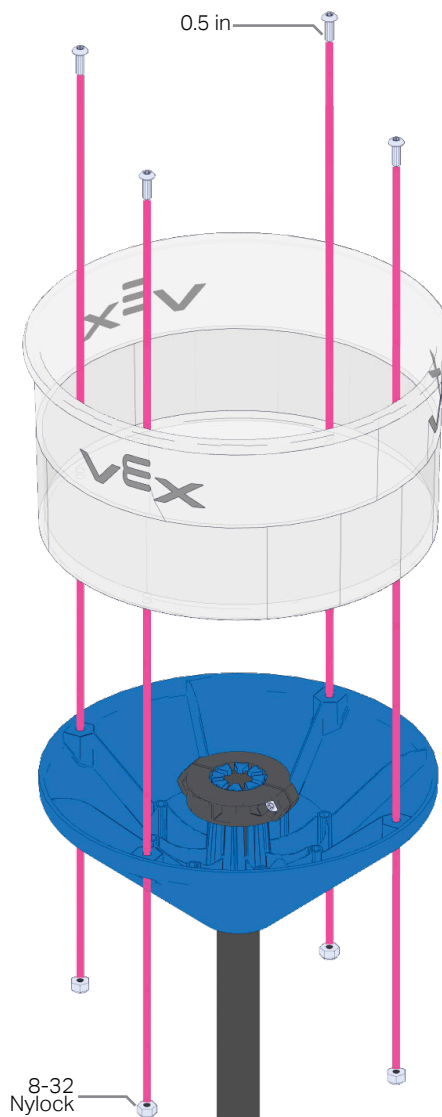

23

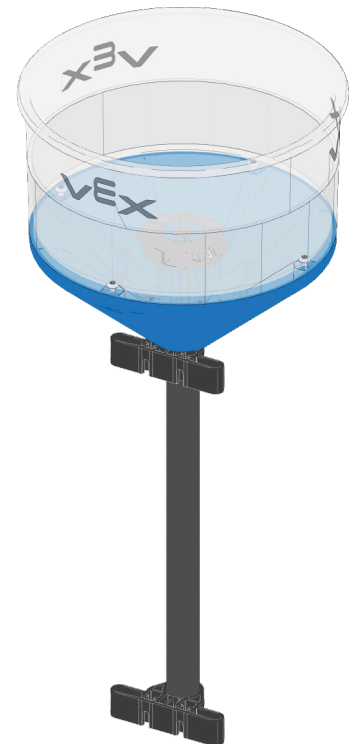
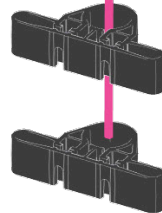
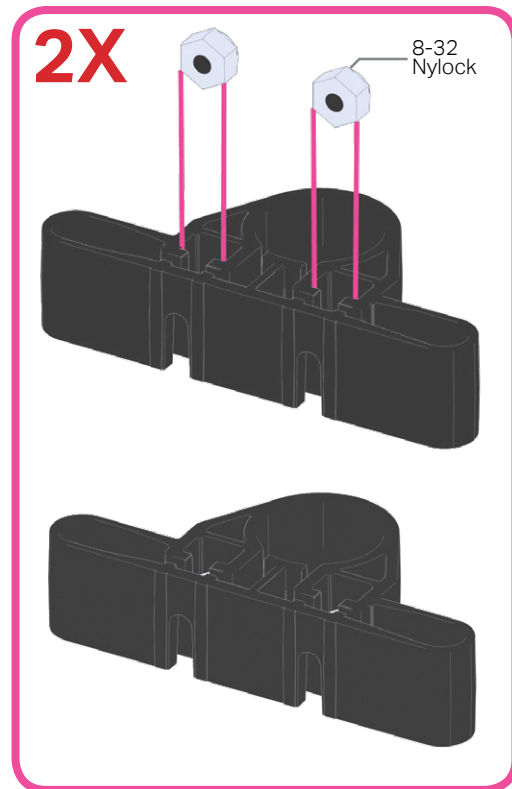
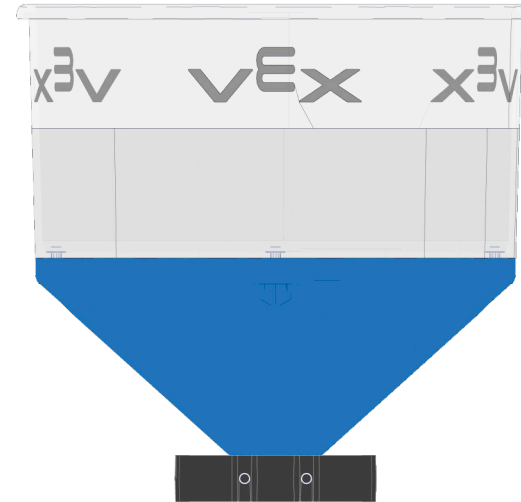
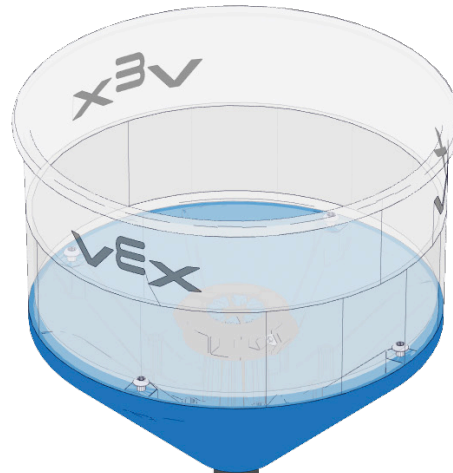
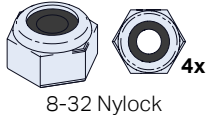

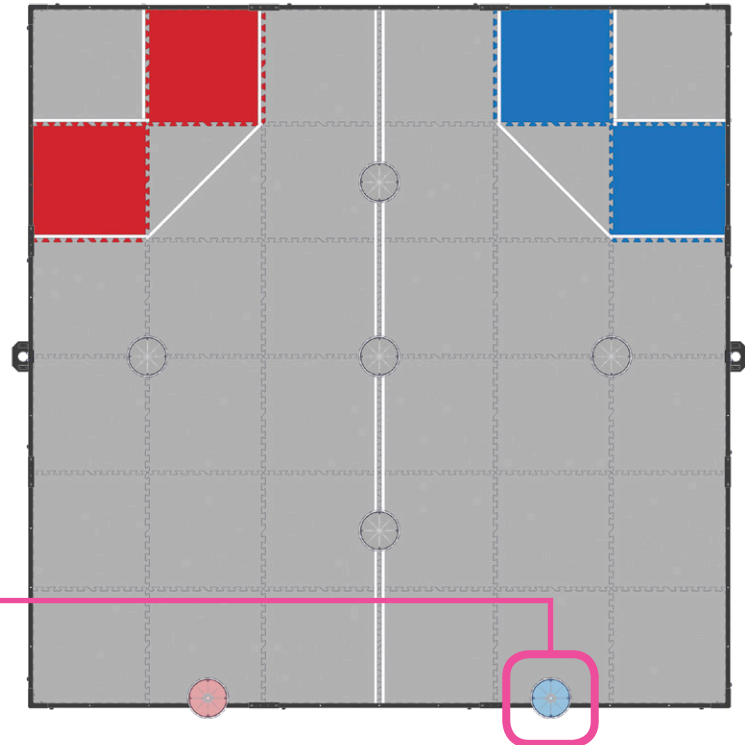
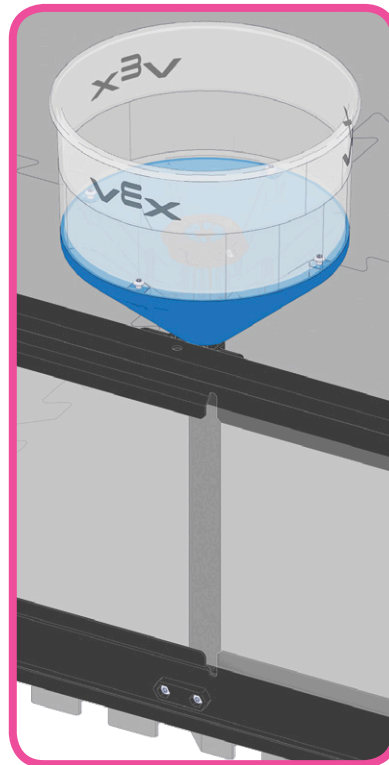
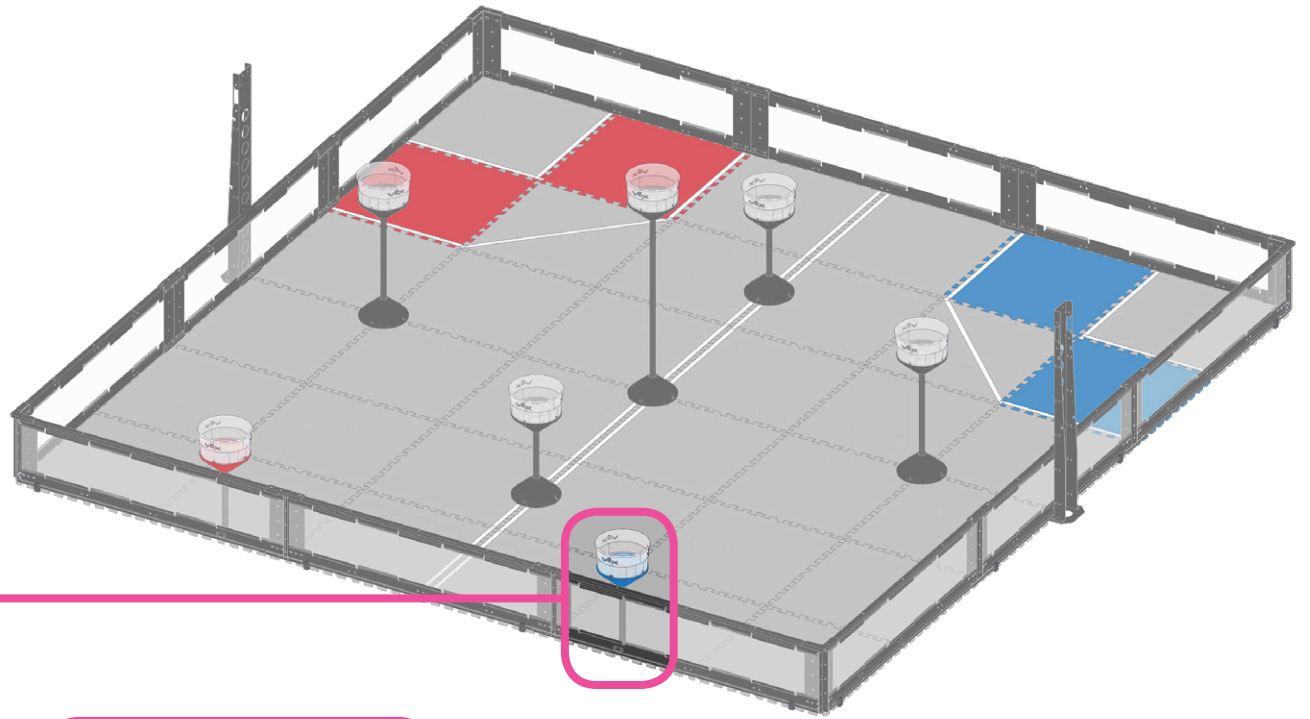
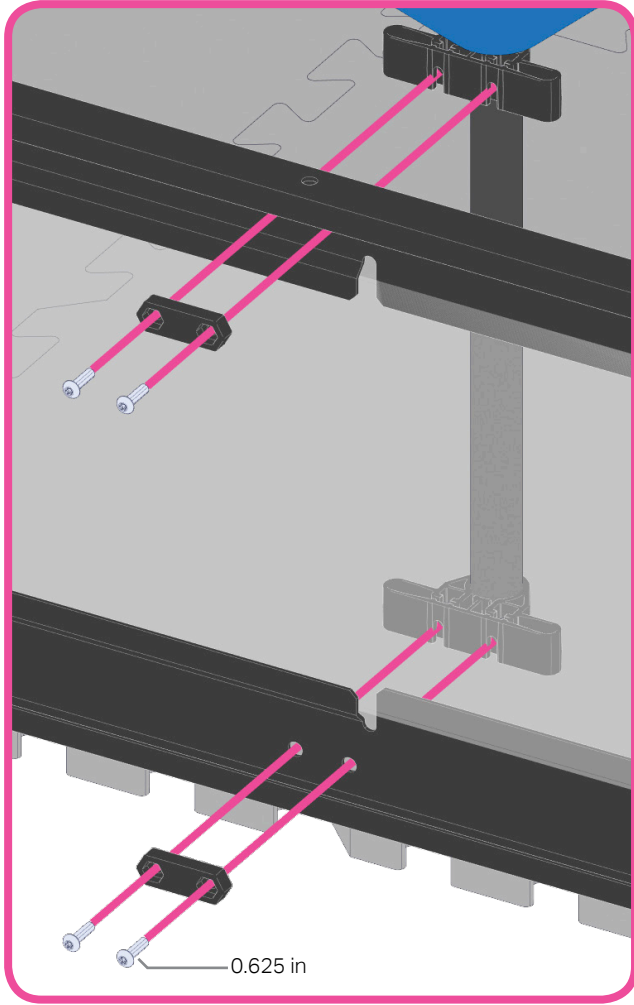

25



4x



0.5 in

4x

8-32 Nylock

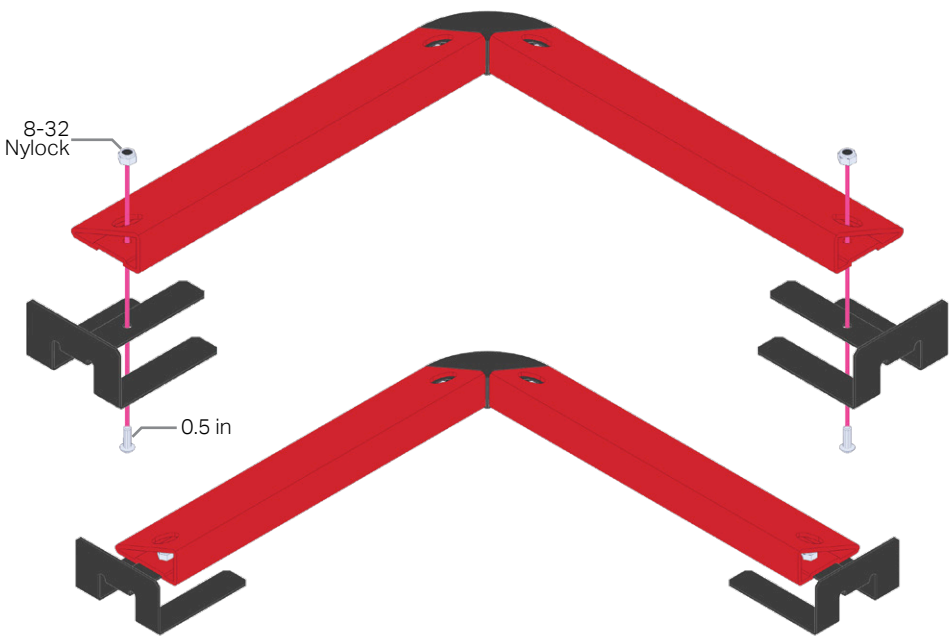
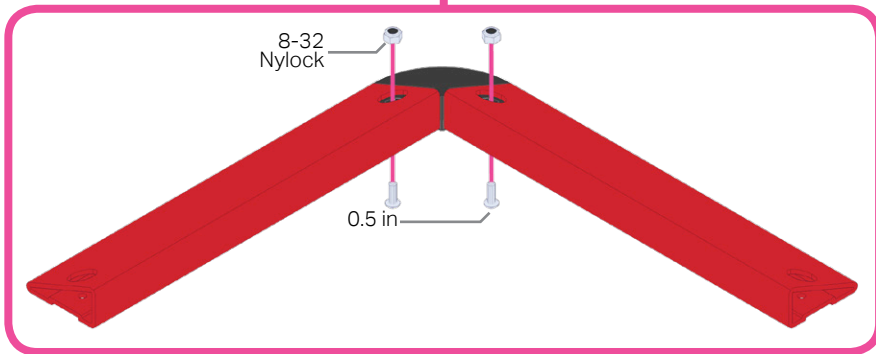
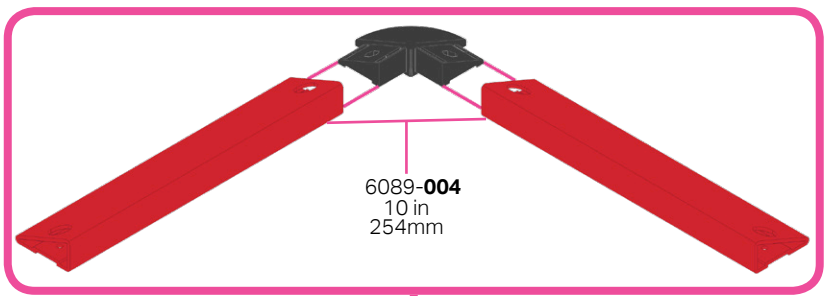

26

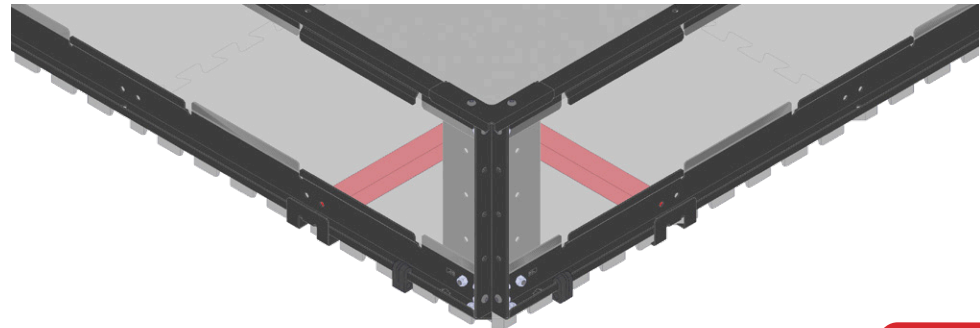
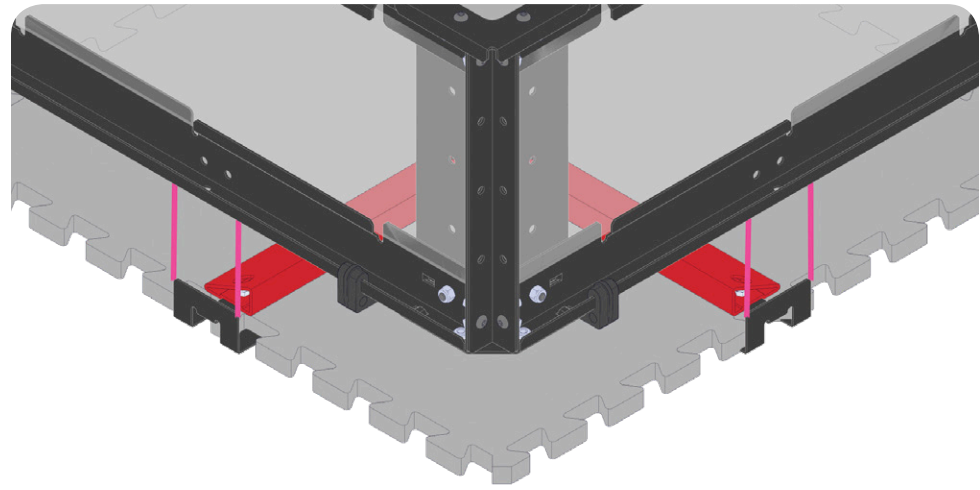
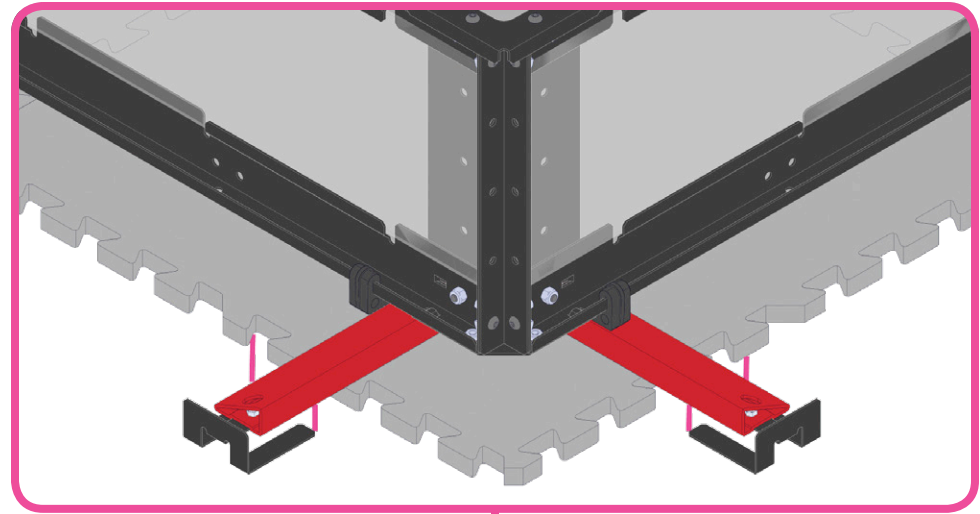

27



4x



0.5 in

4x

8-32 Nylock

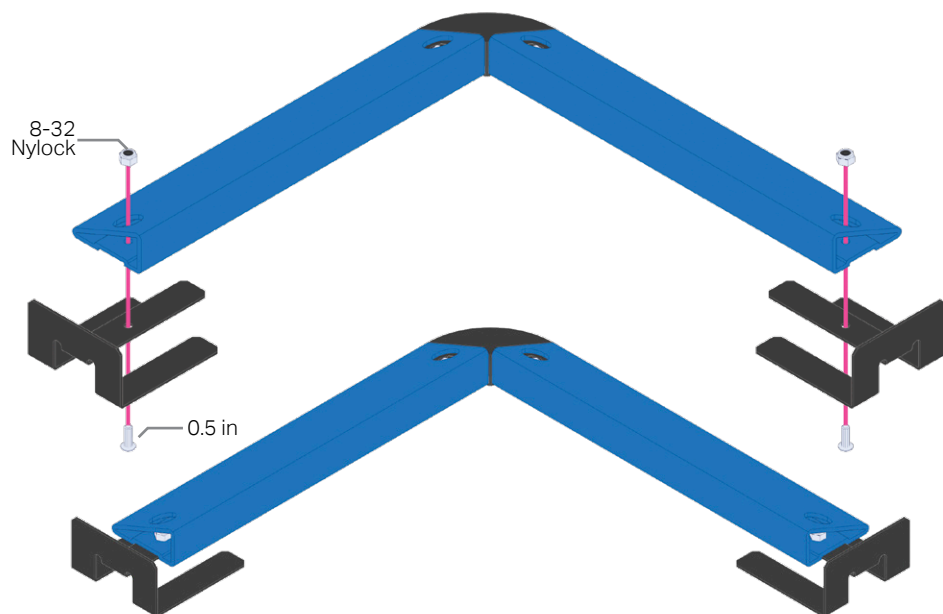
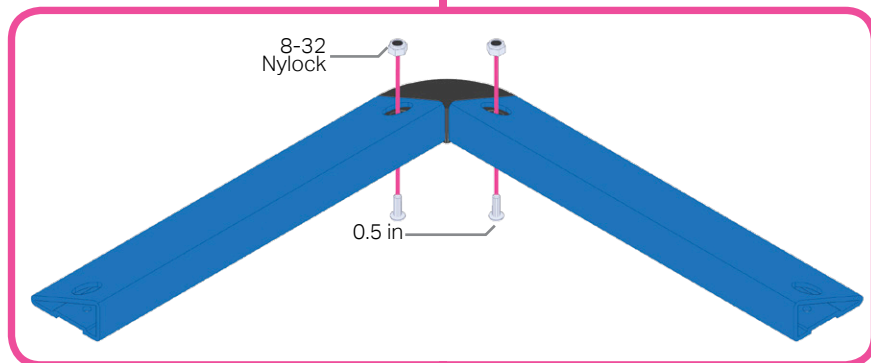
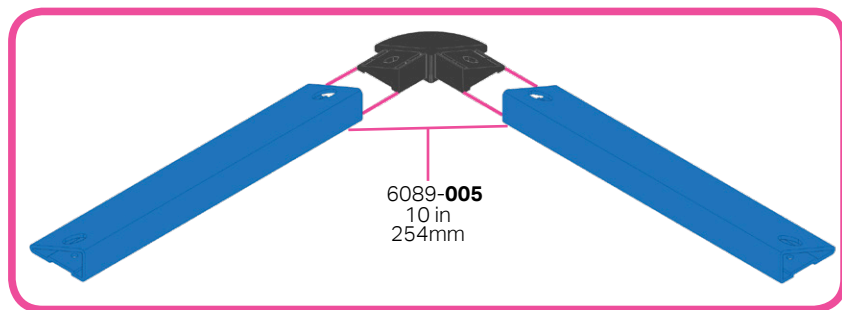

28

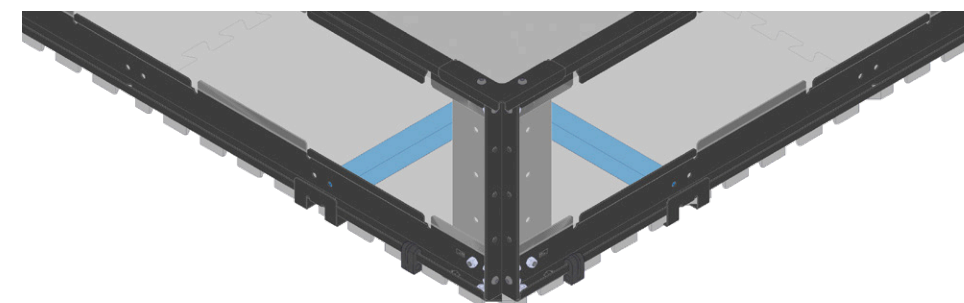
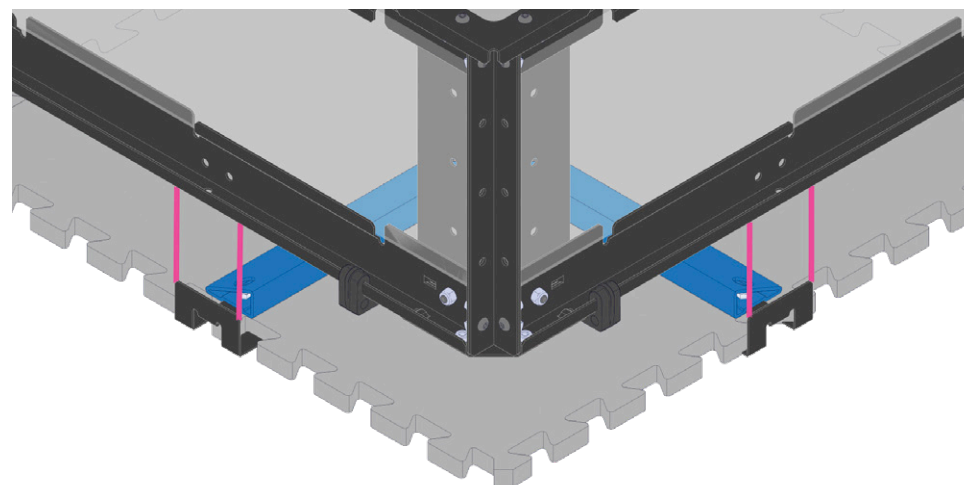
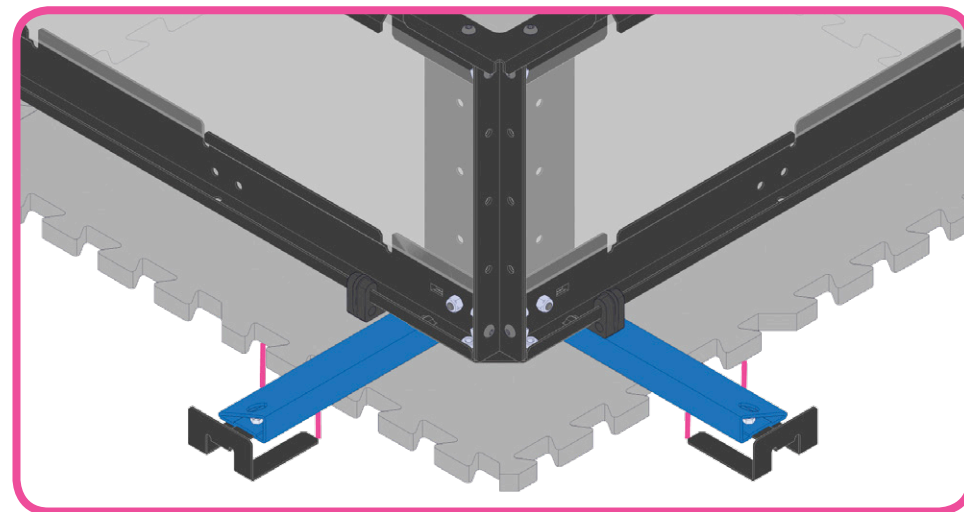

29



4x



0.5 in

4x

8-32 Nylock

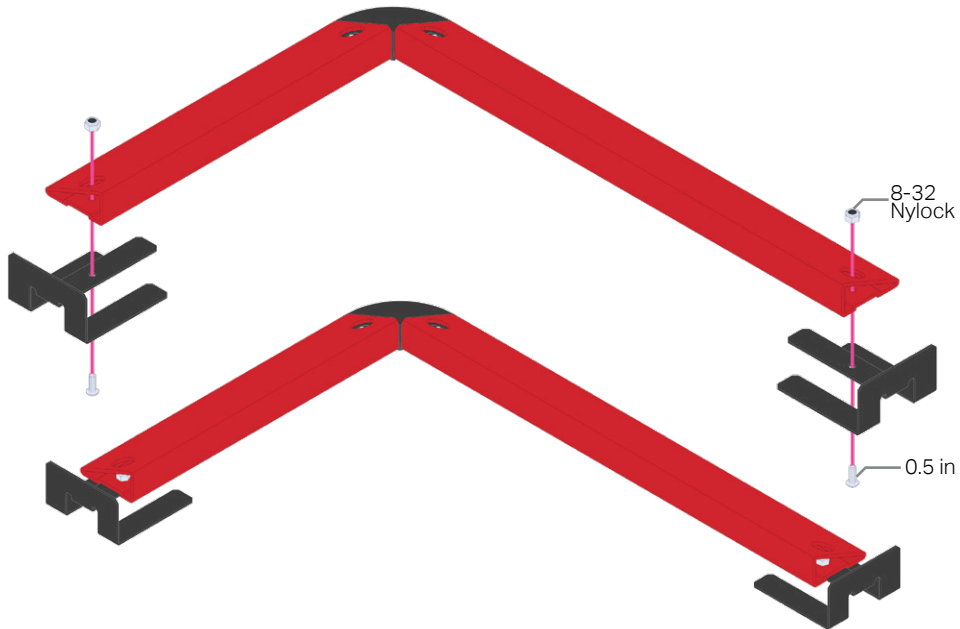
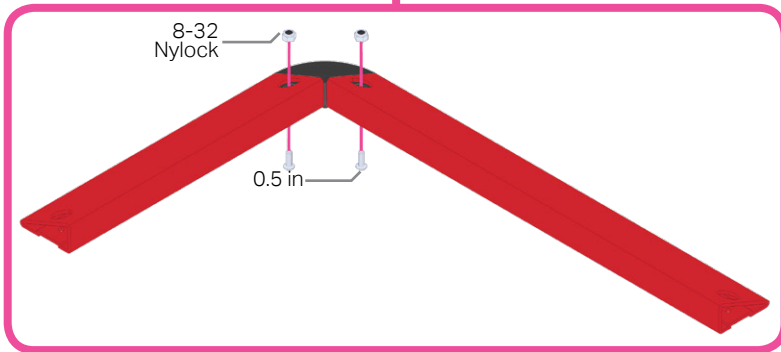
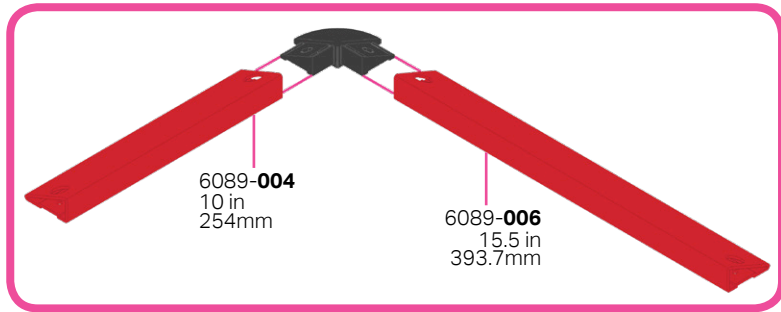

30

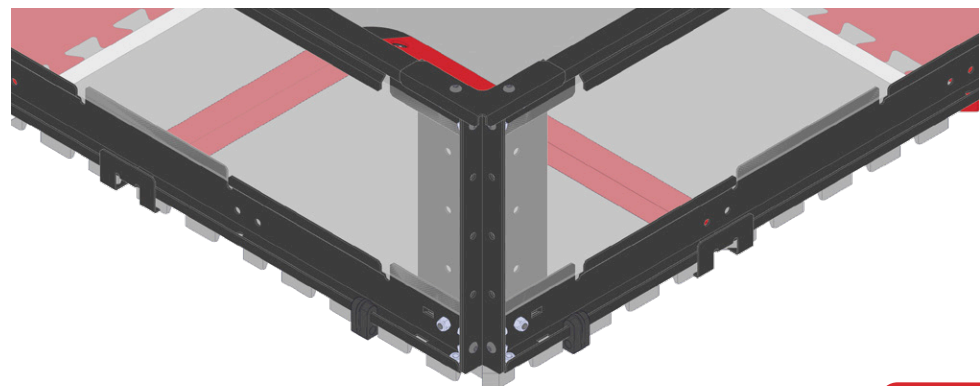
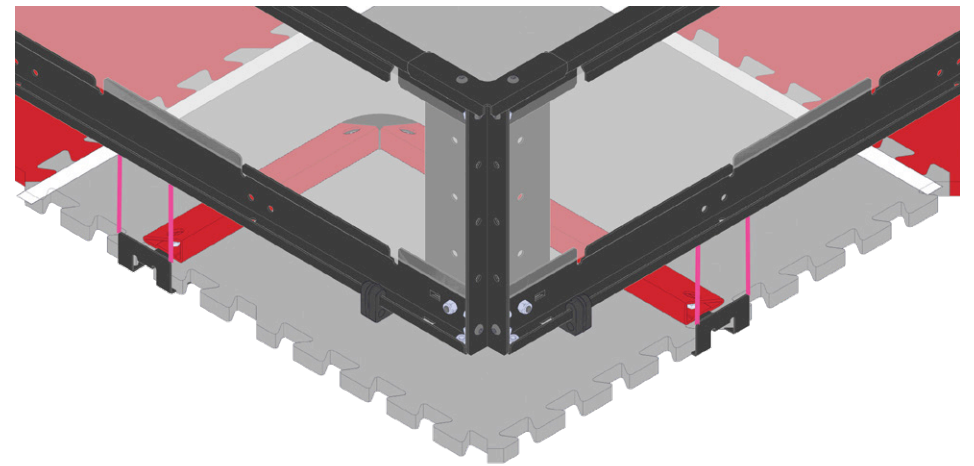
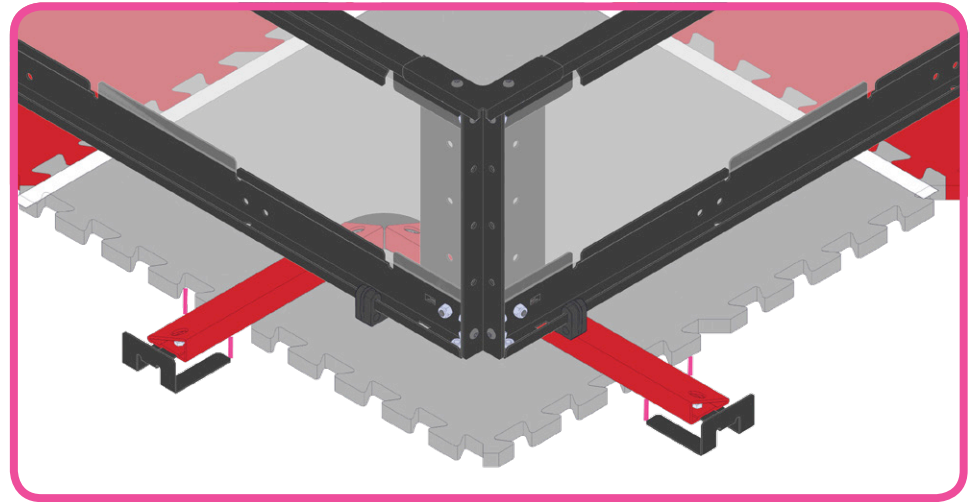

31



4x



0.5 in

4x

8-32 Nylock

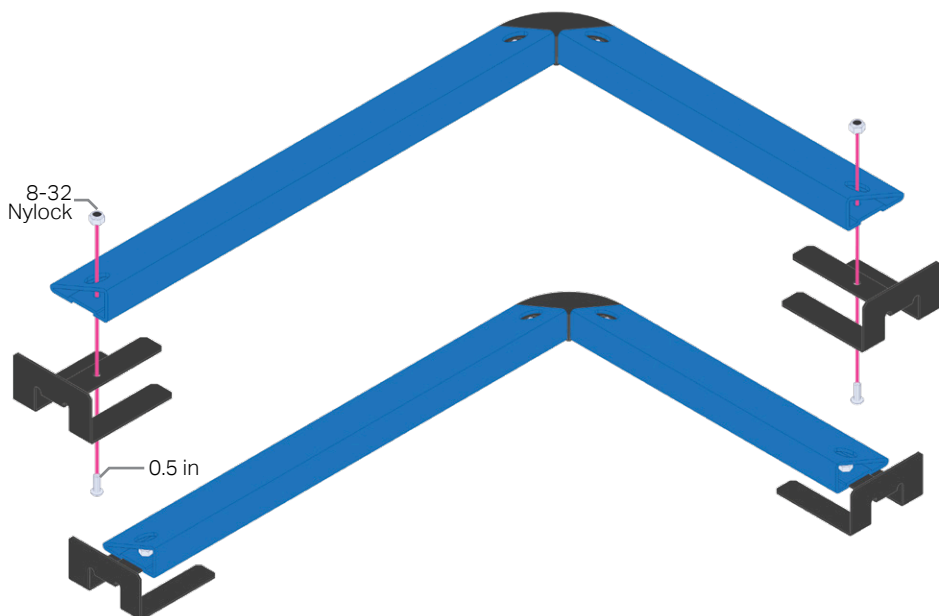
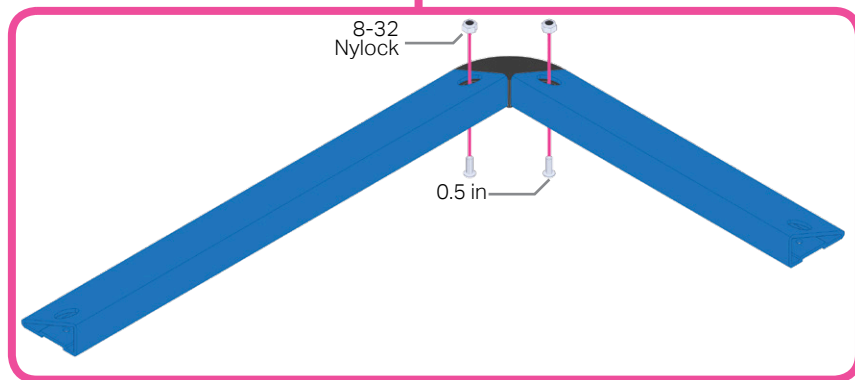
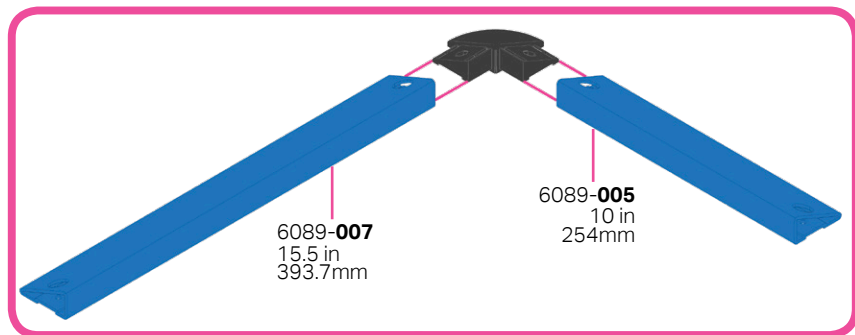

32

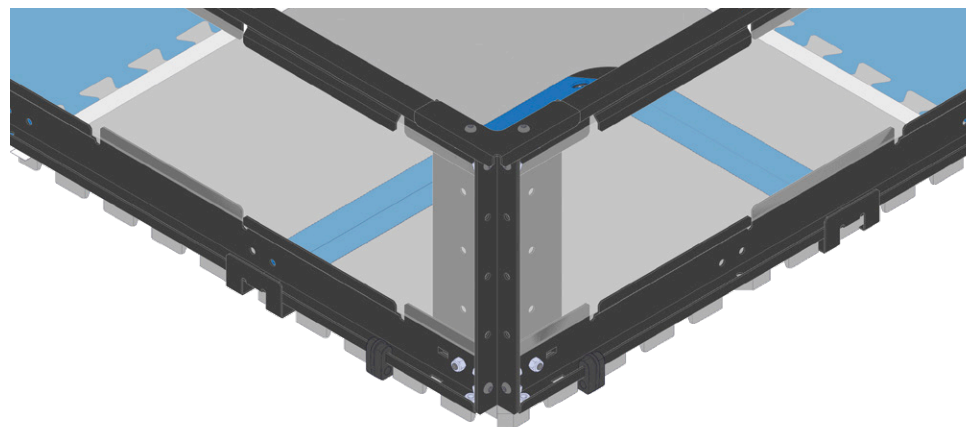
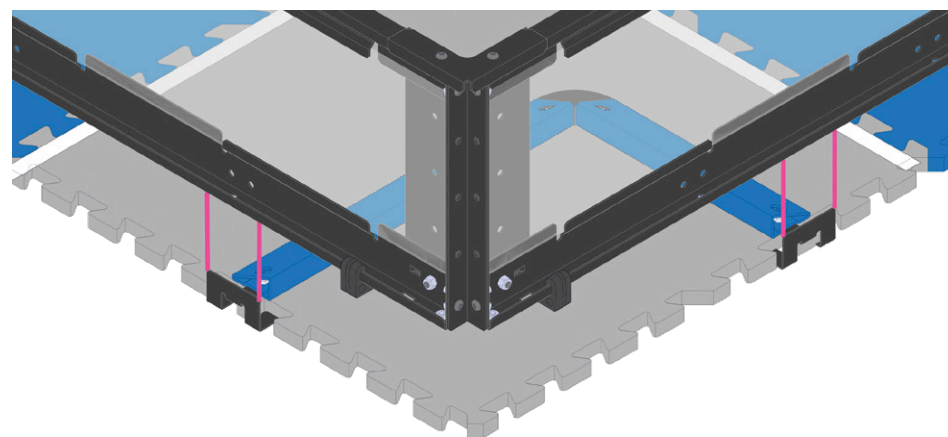
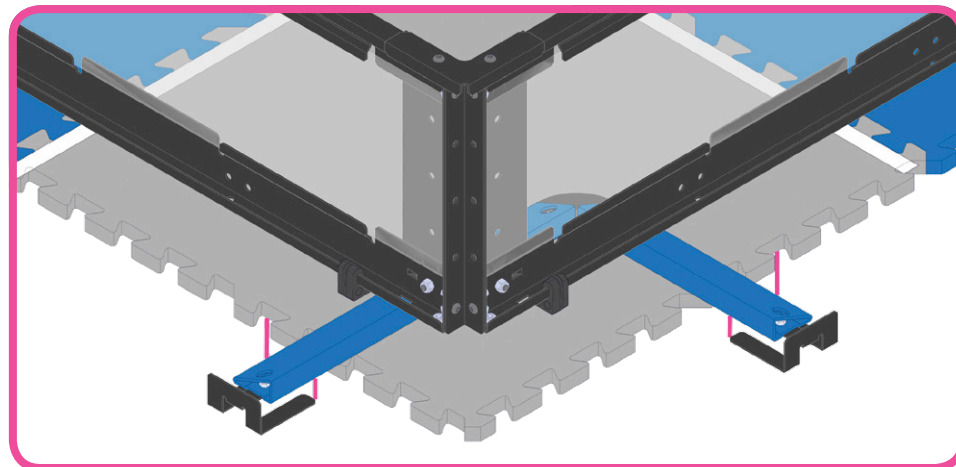

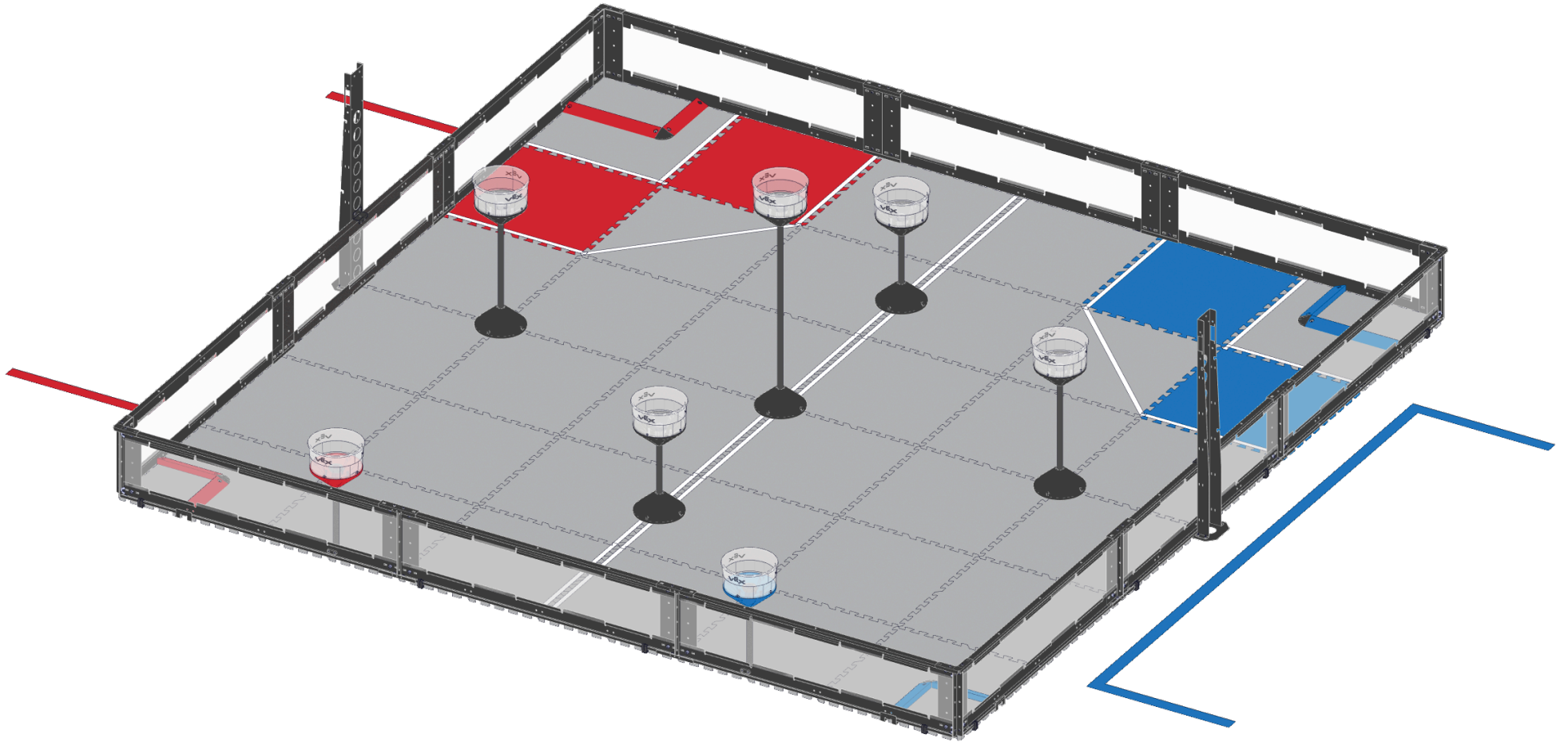

Tower Takeover Game Element Placement

 vexedr.com/current-game

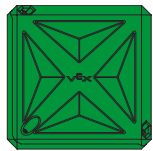

22x

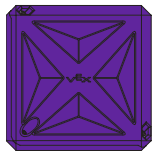

22x

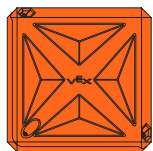

22x

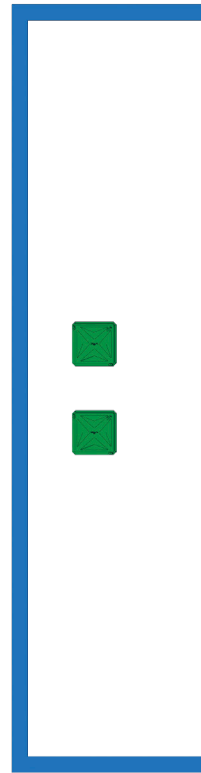
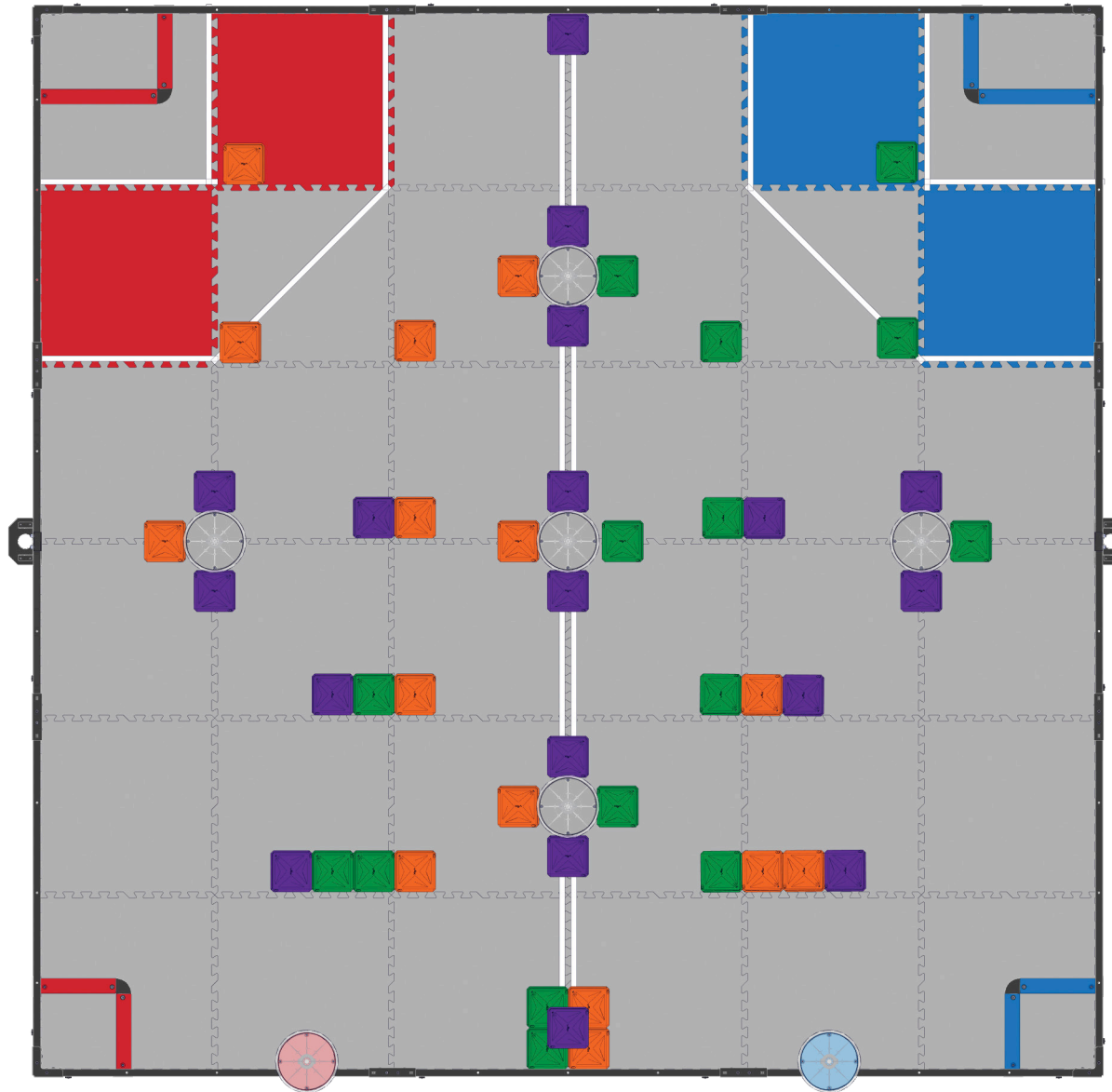
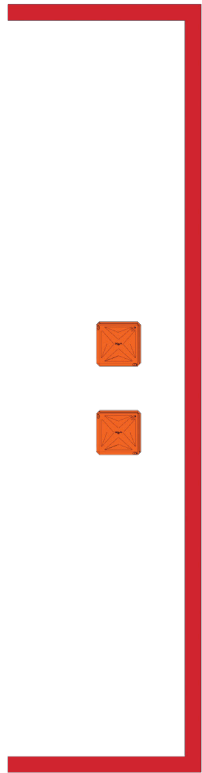

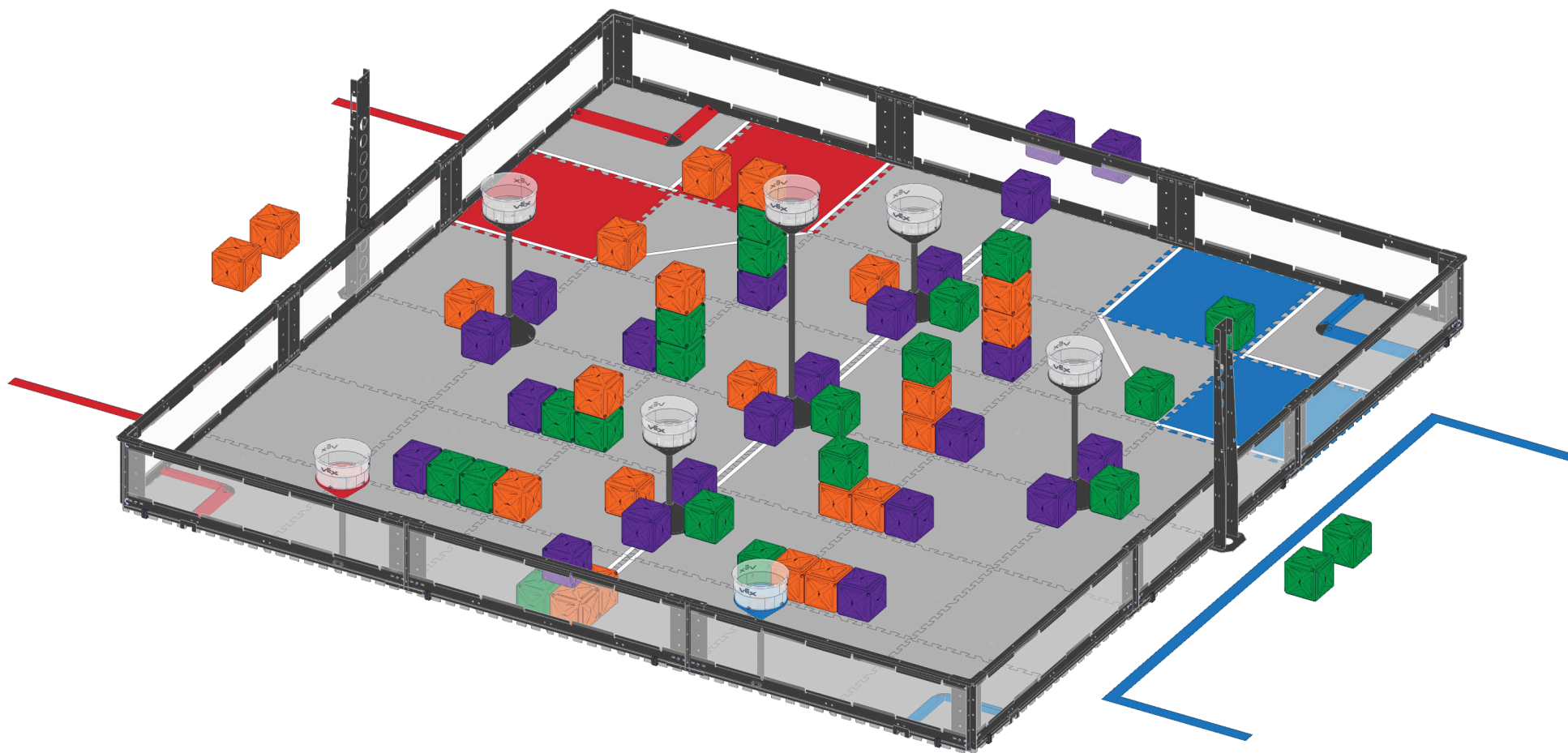

Field Build Instructions

276-6093-750 Rev1



Custom manufactured in China for Innovation First Trading SARL. Distributed in the U.S.A. by VEX Robotics, Inc., 6725 W. FM 1570, Greenville, TX 75402, U.S.A. Distributed in Europe by Innovation First Trading SARL, 21b rue Gabriel Lippmann, L-5365 Munsbach, Luxembourg +352 27 86 04 87. Distributed in Canada by / Distribué au Canada par / Innovation First Trading, Inc., 6725 W. FM 1570, Greenville, TX 75402, U.S.A. ©2018 VEX Robotics, Inc. All rights reserved. Tous droits réservés.